

**MEYERCORD TAX STAMPING
EQUIPMENT**

Manufactured by United Silicone an ITW company

Mechanical Drawings
(Attachment 1)

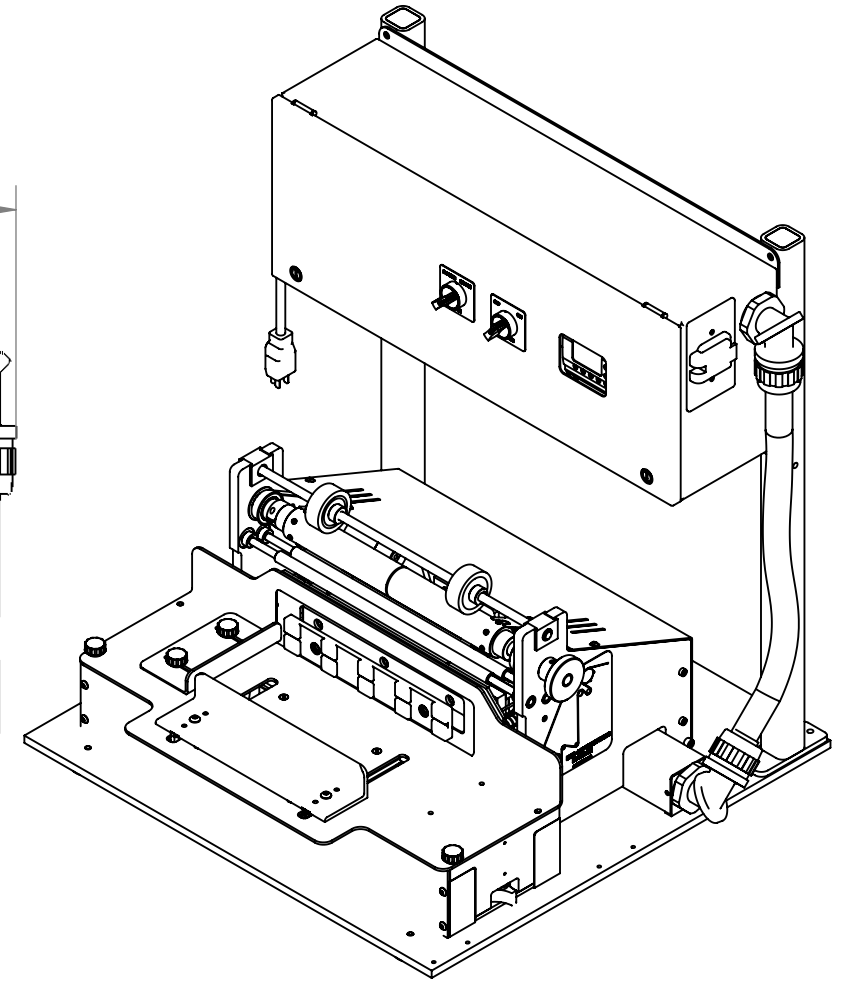
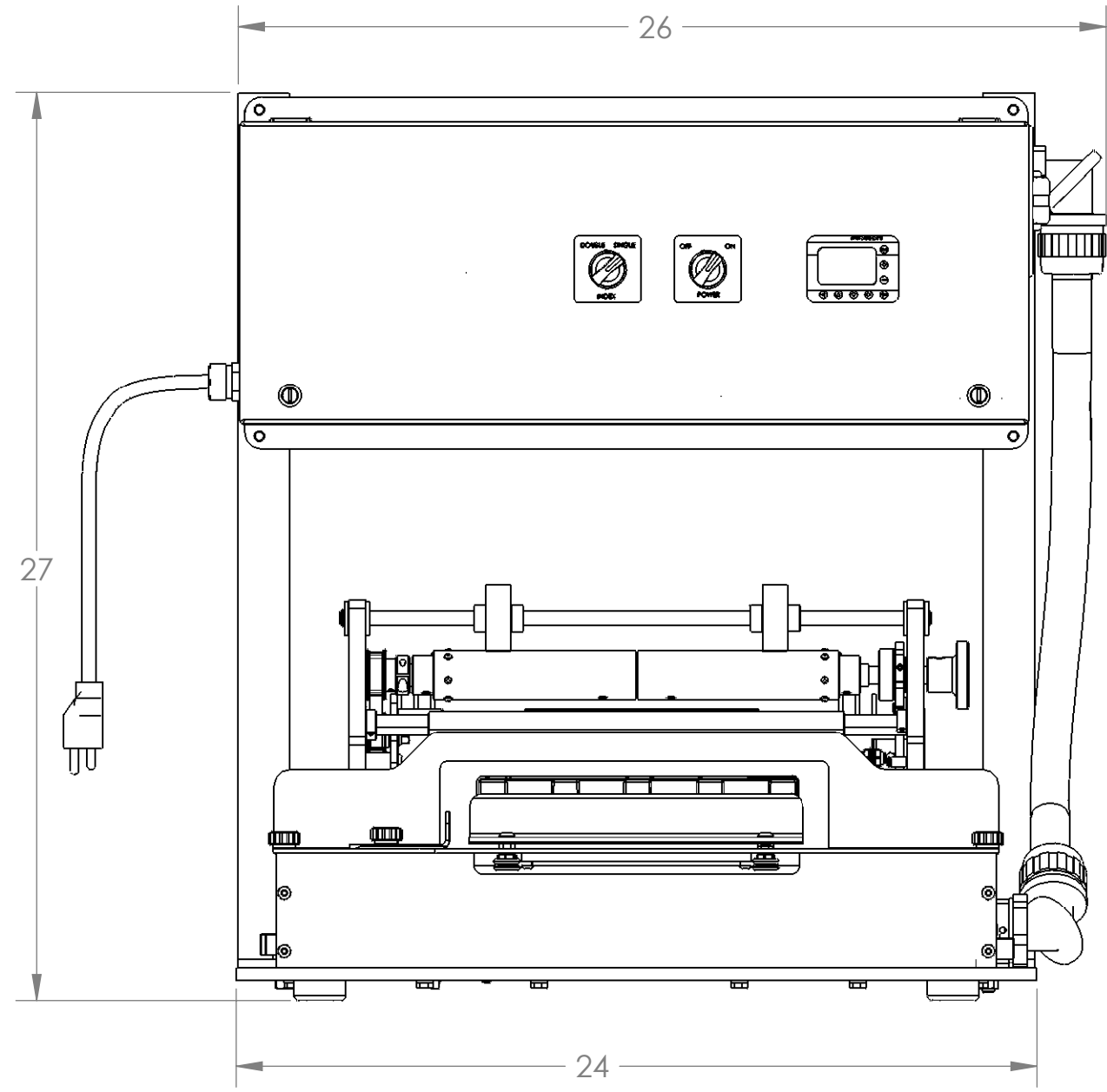
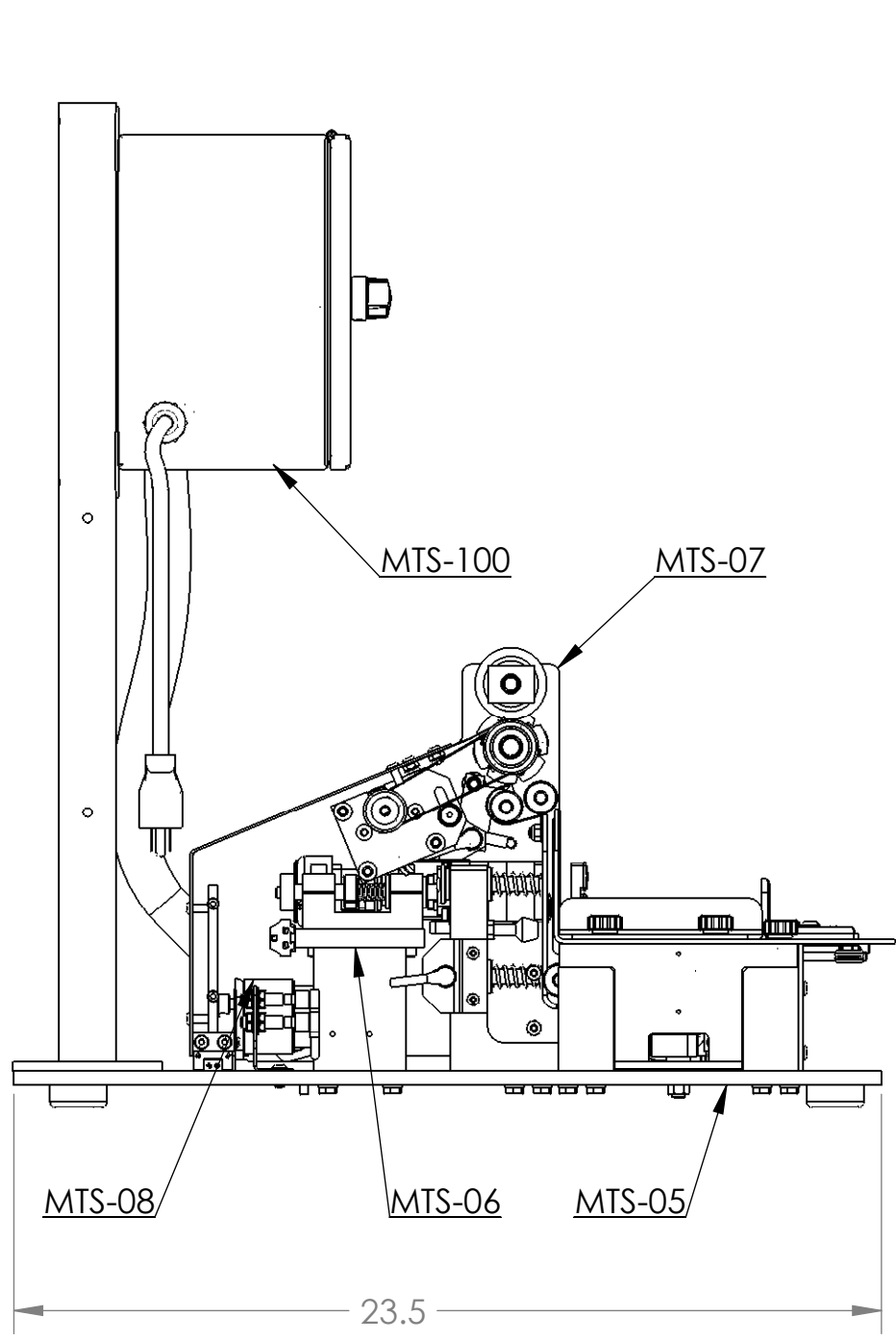

5	MTS-05	BASE & TABLE ASSY	1
4	MTS-06	SOLENOID STAMP HEAD ASSEMBLY	1
3	MTS-07	CARRIAGE ASSEMBLY	1
2	MTS-08	INDEX MOTOR ASSEMBLY	1
1	MTS-100	ELECTRICAL PANEL ASSY	1
ITEM NO.	USIPN	DESCRIPTION	QTY

END PANELS HIDDEN IN THIS VIEW

C	01/16/2009	UPDATE VIEWS TO REFLECT SUB ASSY CHGS ECN 09-1001	WBE
REV.	DATE	DESCRIPTION	APP

TOLERANCES
UNLESS OTHERWISE NOTED
.X = ±.05"
.XX = ±.015"
.XXX = ±.005"
.XXXX = ±.0005
ANGLES = ±1/2°
FRACTIONS = ±1/64"

MATERIAL:
SEE COMPONENT

FINISH:

ALL DIMENSIONS IN INCHES UNLESS OTHERWISE NOTED.
REMOVE ALL SHARP EDGES.
CONFORMANCE: ASME Y14.5M-1994

PRODUCT: MTS
SHEET: 1 OF 1

MEYERCORD
Tax Stamping Equipment

**MANUAL STAMP
MACHINE ASSEMBLY**

DESIGN: WBE DRAWN: 01/28/08
SCALE: 1:5 APPRD: DWG

MTS-02 **C**
DWG REV

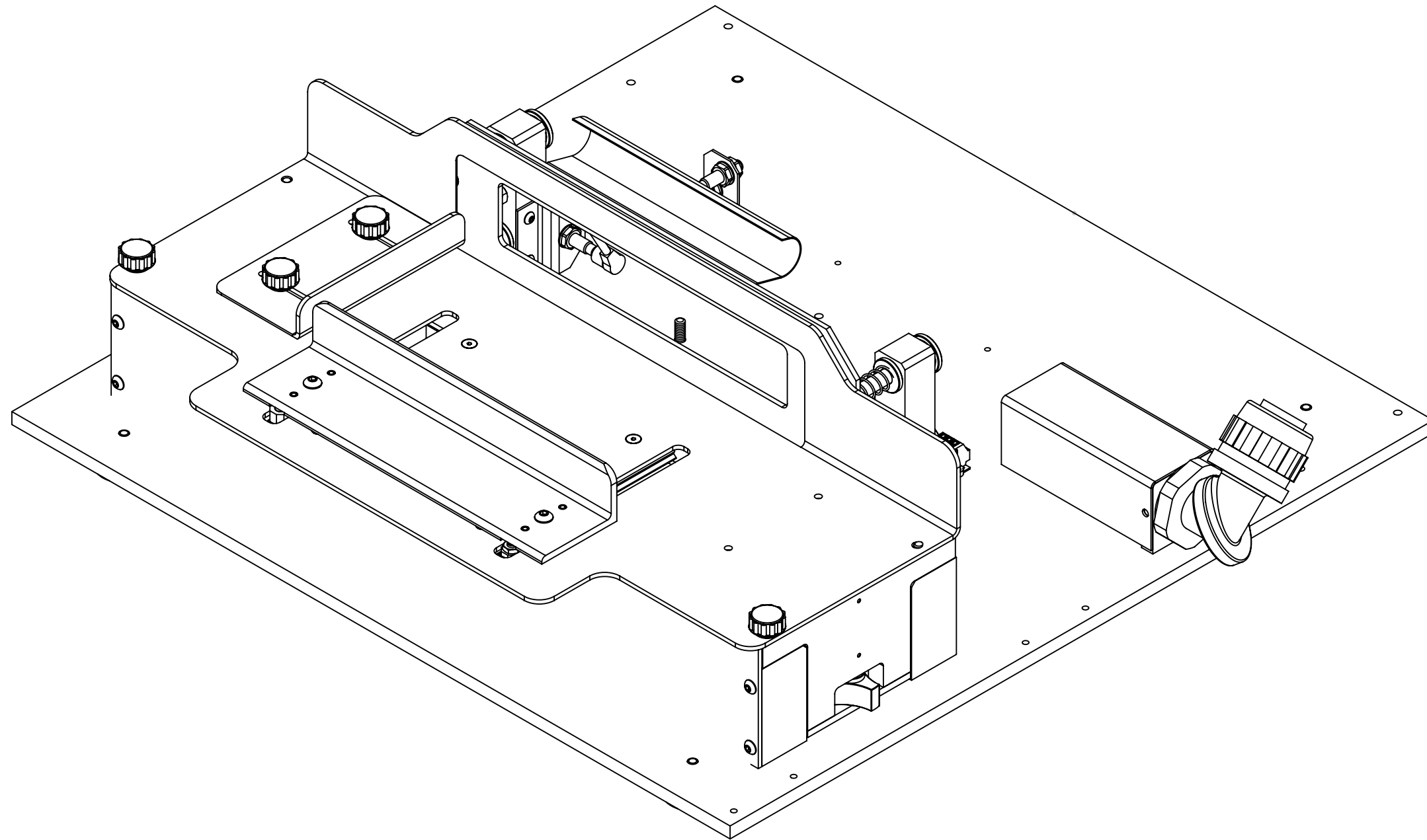

60		1/4-20 JAM NUT	2
59		NYLON LOCK HEX NUT 10-32	2
58		M6 x 1 HEX JAM NUT	2
57		M3 x 10 SHCS	8
56		LOCK WASHER 1/4"	4
55		FHSCS 6-32 x 1/2" LG	8
54		FHSCS 10-32 x 1/2" LG	6
53		DOWEL PIN 1/4 x 1/2	2
52		8-32 x 3/8 FL HD SCR	6
51		8-32 BHCS	2
50		5/16-18 x 1.75 SHCS	1
49		5/16-18 X 1 3/4 FULL THD HH BOLT	2
48		3/8 HARDENED WASHER	4
47		3/16" X 1/2" DOWEL PIN	4
46		10-32 X 1/2 BUTTON HEAD SCR	11
45		1/4-20 x 3/4 HEX HD SCR	4
44		1/4-20 x 1/2 LG BHCS	2
43		#8-32 X 3/8 BUTT HD SCR	8
42	104703	1/4 LOC WASHER	16
41	105693	1/4-20 x 1" HEX HD SCR	16
40	196267	RUBBER FOOT	4
39	41124043	PROXIMITY SENSOR	3
38	41124047	RA FEMALE - STRAIGHT MALE	3
37	41132135	1" MULTI-POSITION FITTING	1
36	41135061	END PLATE	2
35	41135063	DBL TERMINAL BLOCK	3
34	41135072	TERMINAL	15
33	41178617	3/8 ID LINEAR BALL BEARING	4
32	41179118	CUSHIONED SPINDLE	2
31	41234032	3 ARM KNOB	2
30	41234033	PLASTIC KNOB w 10-32 THD	4
29	41242001	#10-32 SPRING PLUNGER	2
28	41242044	COMPRESSION SPRING	4
27	41249128	3/8 ID EPDM WASHER	4
26	41249129	FLAT WASHER	4
25	41249136	METRIC V-GROOVE TRACK ROLLER	2
24	41249137	METRIC V-GROOVE TRACK ROLLER	2
23	MTS-0502	SLIDE SUPPORT	2
22	MTS-0503	SWITCH MOUNTING PLATE	1
21	MTS-0504	SPRING PLATE	1
20	MTS-0507	COVER PLATE	1
19	MTS-0508	ADJUSTABLE STOP	1
18	MTS-0511	FRONT COVER	1
17	MTS-0516	PROX MOUNTING BRACKET	1
16	MTS-0520	BASE PLATE	1
15	MTS-0522	CONNECTING STRAP	2
14	MTS-0525	PUSH BAR	1
13	MTS-0527	SLIDE SPACER	1
12	MTS-0528	SLIDE SPACER	1
11	MTS-0529	RAIL MOUNTING PLATE	1
10	MTS-0530	TABLE END PLATE	2
9	MTS-0531	SUPPORT POST 1	2
8	MTS-0532	SUPPORT POST 2	2
7	MTS-0533	ADJUSTMENT LOC BAR	2
6	MTS-0537	TRACK ROLLER RAIL	2
5	MTS-0540	CONDUIT MTG PLATE	1
4	MTS-0541	WIRING COVER	1
3	MTS-0542	LINEAR SLIDE ASSY	2
2	MTS-0543	PAPER GUIDE	1
1	SSM-8602	GUIDE SHAFT	4
ITEM NO.	USIPN	DESCRIPTION	QTY

REV.	DATE	DESCRIPTION	APP
C	01/16/2009	ADD MTS-0522 & 0540 THRU 0543, OMIT MTS-0534 & 0535 ECN 09-1001	WBE

TOLERANCES
UNLESS OTHERWISE NOTED
.X = ±.05"
.XX = ±.015"
.XXX = ±.005"
.XXXX = ±.0005"
ANGLES = ±1/2°
FRACTIONS = ±1/64"

MATERIAL: SEE COMPONENTS
FINISH: NONE

ALL DIMENSIONS IN INCHES UNLESS OTHERWISE NOTED.
REMOVE ALL SHARP EDGES.
CONFORMANCE: ASME Y14.5M-1994

PRODUCT: HTS
SHEET: 1 OF 3

 MEYERCORD
Tax Stamping Equipment

BASE & TABLE ASSY

DESIGN: WBE DRAWN: 01/28/08
SCALE: 1:3 APPRD: MTS-05 C
DWG REV

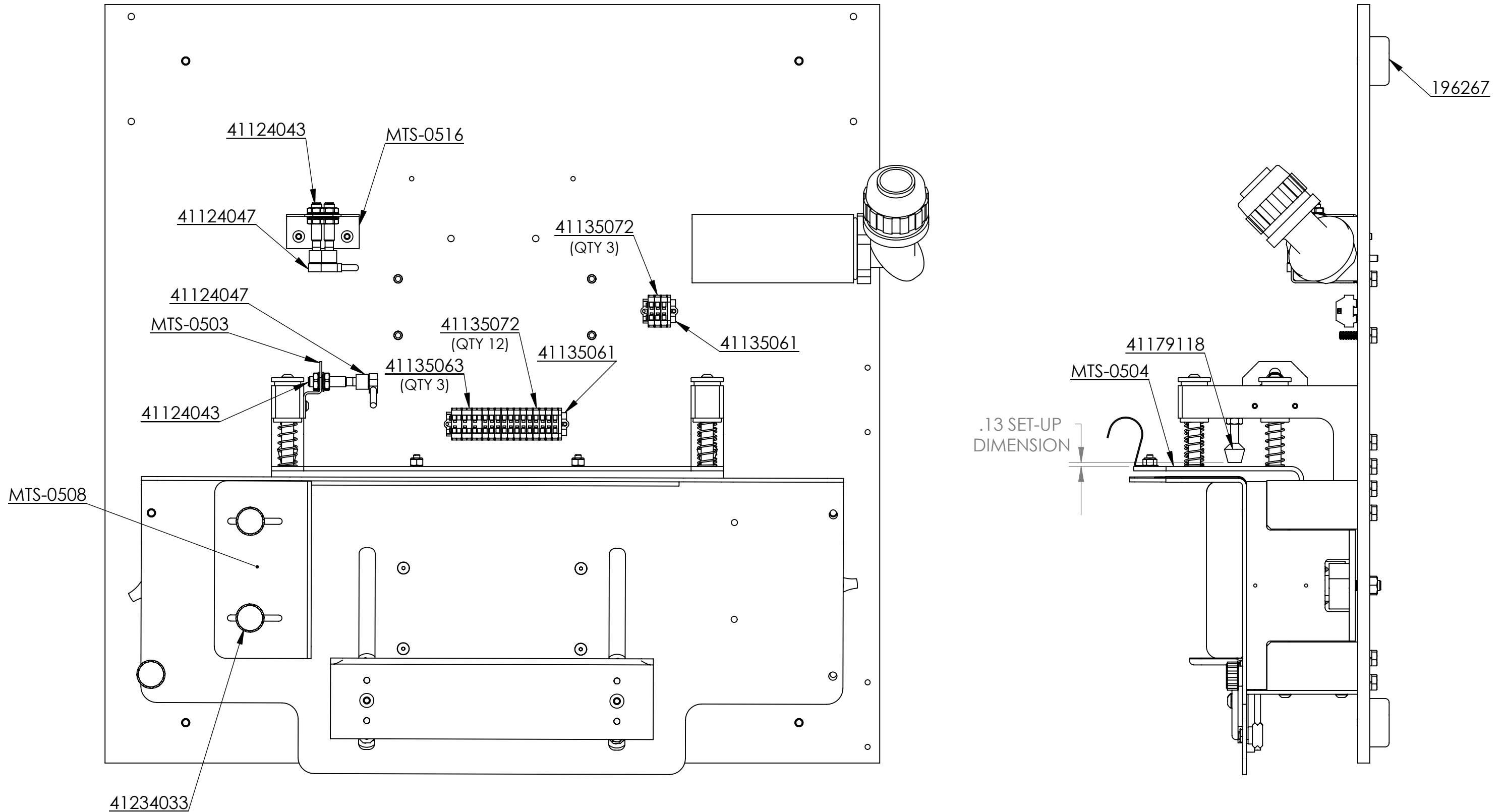

REV.	DATE	DESCRIPTION	APP
C	01/16/2009	ADD MTS-0522 & 0540 THRU 0543, OMIT MTS-0534 & 0535 ECN 09-1001	WBE

TOLERANCES
UNLESS OTHERWISE NOTED
.X = ±.05"
.XX = ±.015"
.XXX = ±.005"
.XXXX = ±.0005
ANGLES = ±1/2°
FRACTIONS = ±1/64"

MATERIAL:
SEE COMPONENTS

FINISH:
NONE

ALL DIMENSIONS IN INCHES UNLESS OTHERWISE NOTED.
REMOVE ALL SHARP EDGES.
CONFORMANCE: ASME Y14.5M-1994

PRODUCT: **MTS**
SHEET: 2 OF 3

 **MEYERCORD**
Tax Stamping Equipment

BASE & TABLE ASSY

DESIGN: WBE
SCALE: 1:3

DRAWN: 01/28/08
APPRD:

MTS-05
DWG

C
DWG REV

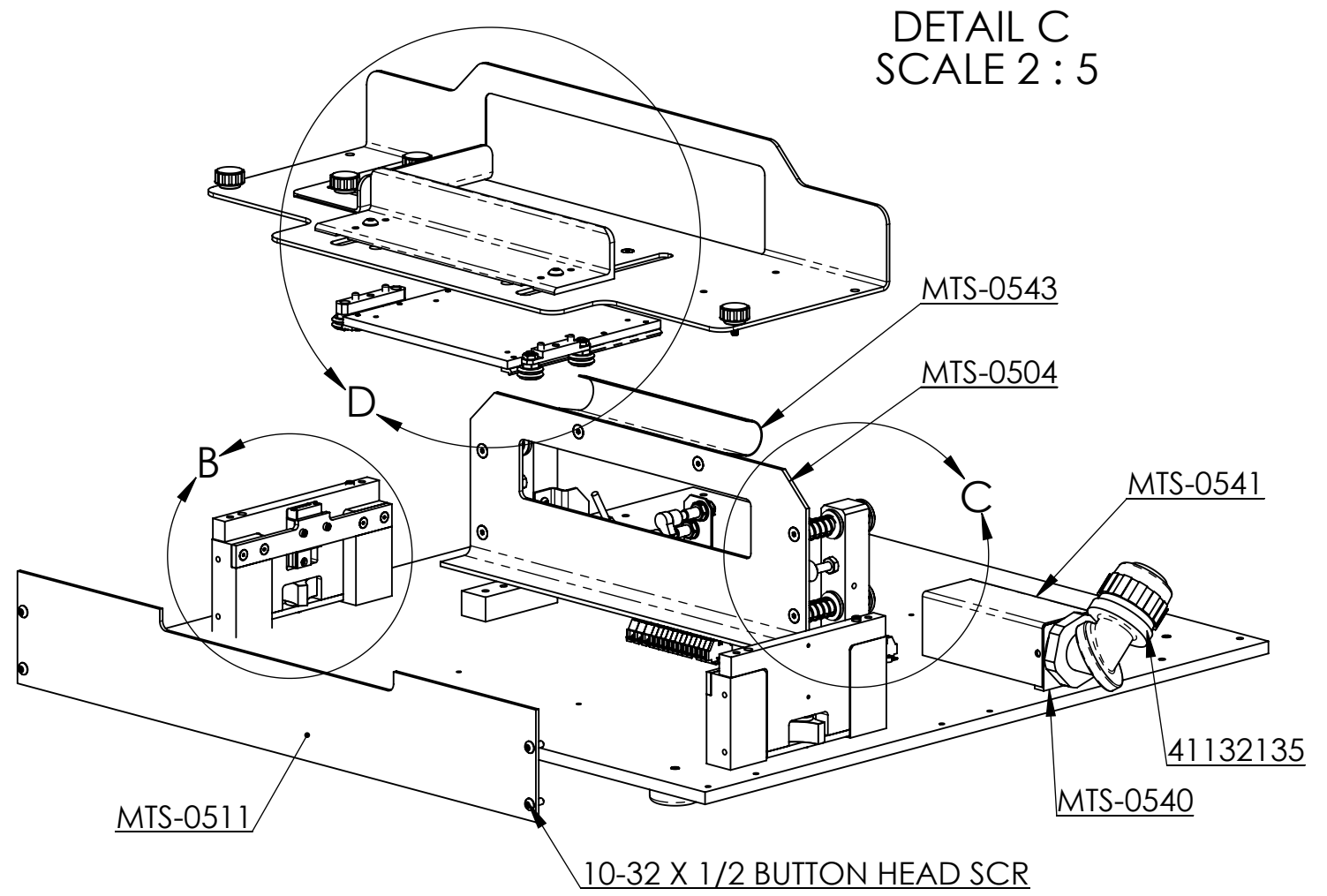
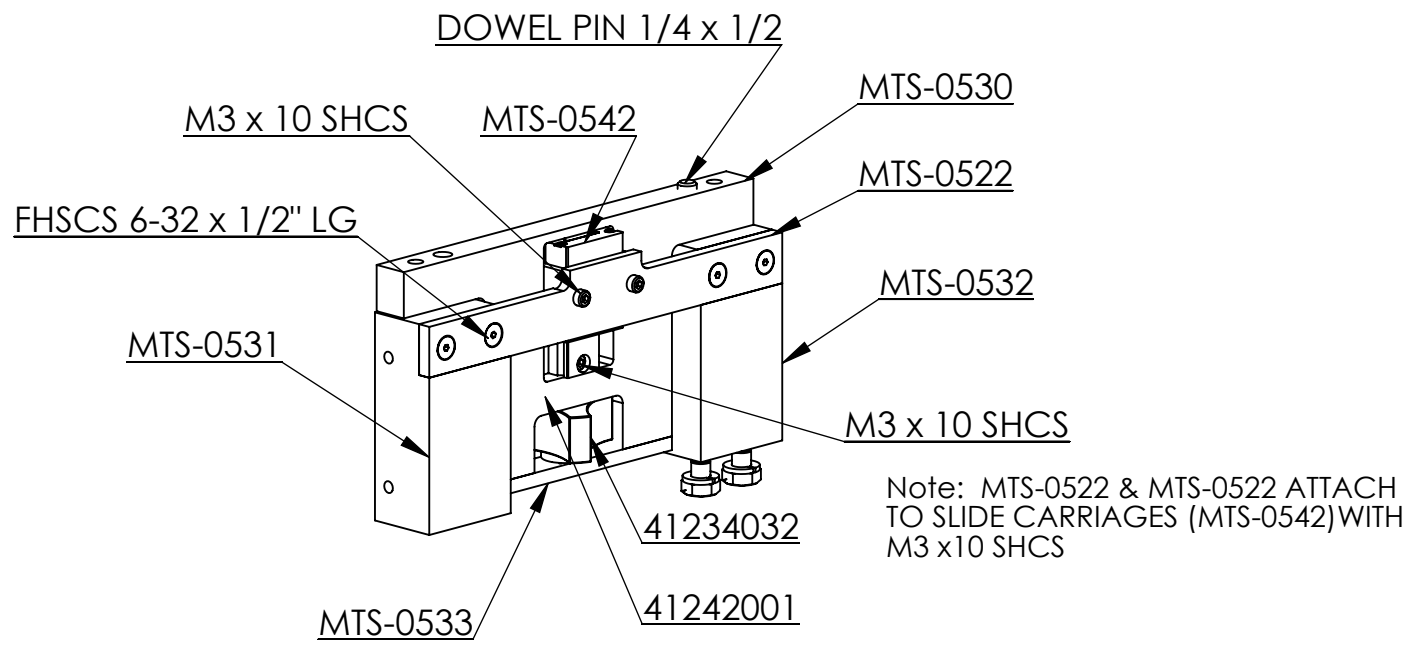
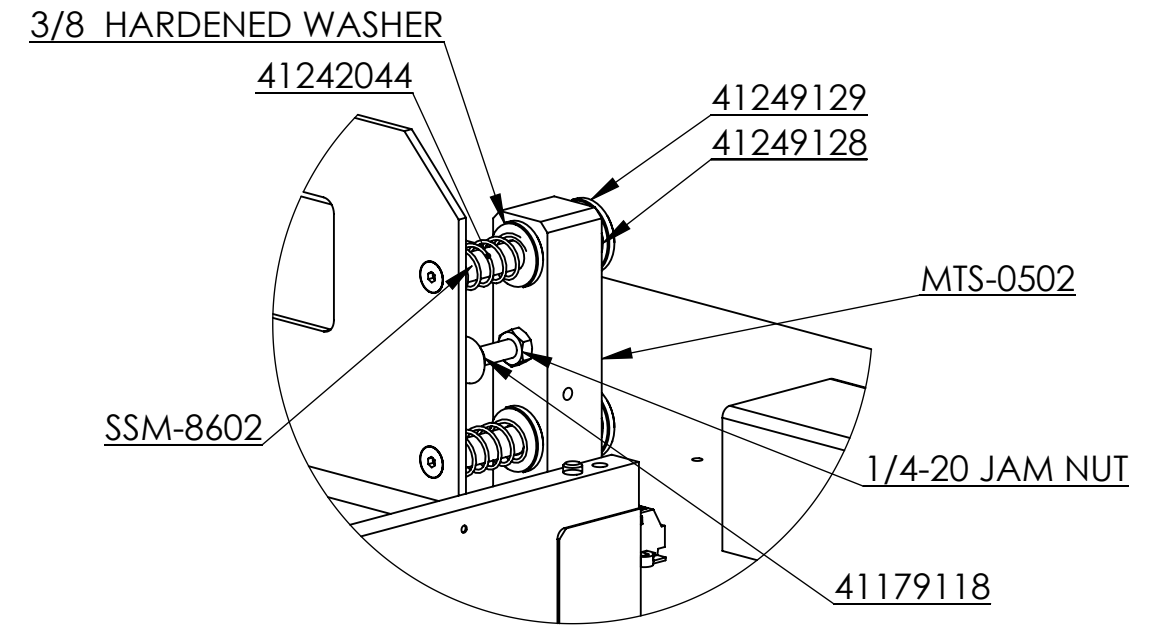
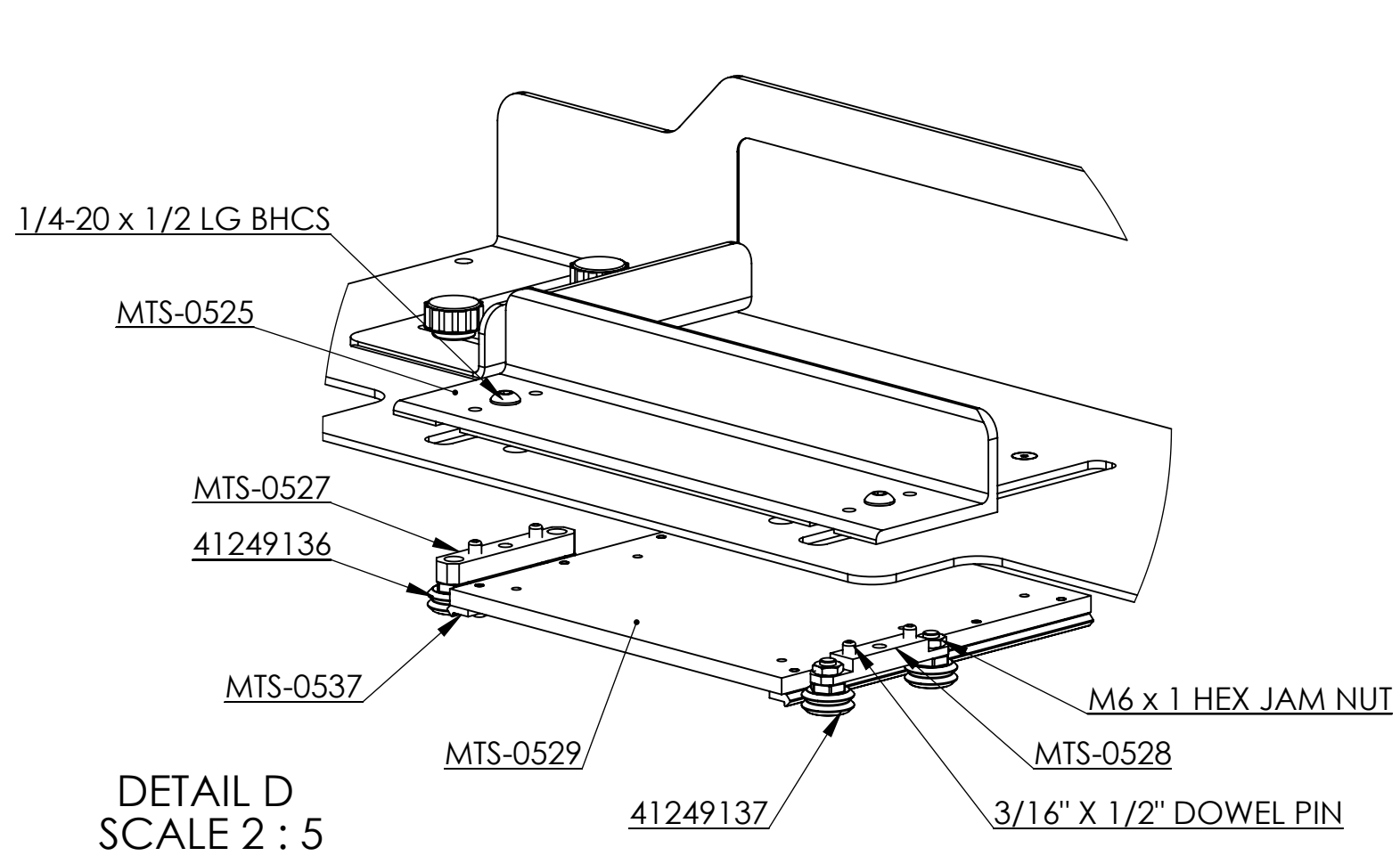

DETAIL B
SCALE 2 : 5

DETAIL C
SCALE 2 : 5

REV.	DATE	DESCRIPTION	APP
C	01/16/2009	ADD MTS-0522 & 0540 THRU 0543, OMIT MTS-0534 & 0535 ECN 09-1001	WBE

TOLERANCES UNLESS OTHERWISE NOTED .X = ±.05" .XX = ±.015" .XXX = ±.005" .XXXX = ±.0005 ANGLES = ±1/2° FRACTIONS = ±1/64"	MATERIAL: SEE COMPONENTS	PRODUCT: MTS
	FINISH: NONE	SHEET: 3 OF 3
ALL DIMENSIONS IN INCHES UNLESS OTHERWISE NOTED. REMOVE ALL SHARP EDGES. CONFORMANCE: ASME Y14.5M-1994		MEYERCORD Tax Stamping Equipment

BASE & TABLE ASSY		MTS-05 C DWG REV
DESIGN: WBE	DRAWN: 01/28/08	
SCALE: 1:5	APPRD:	

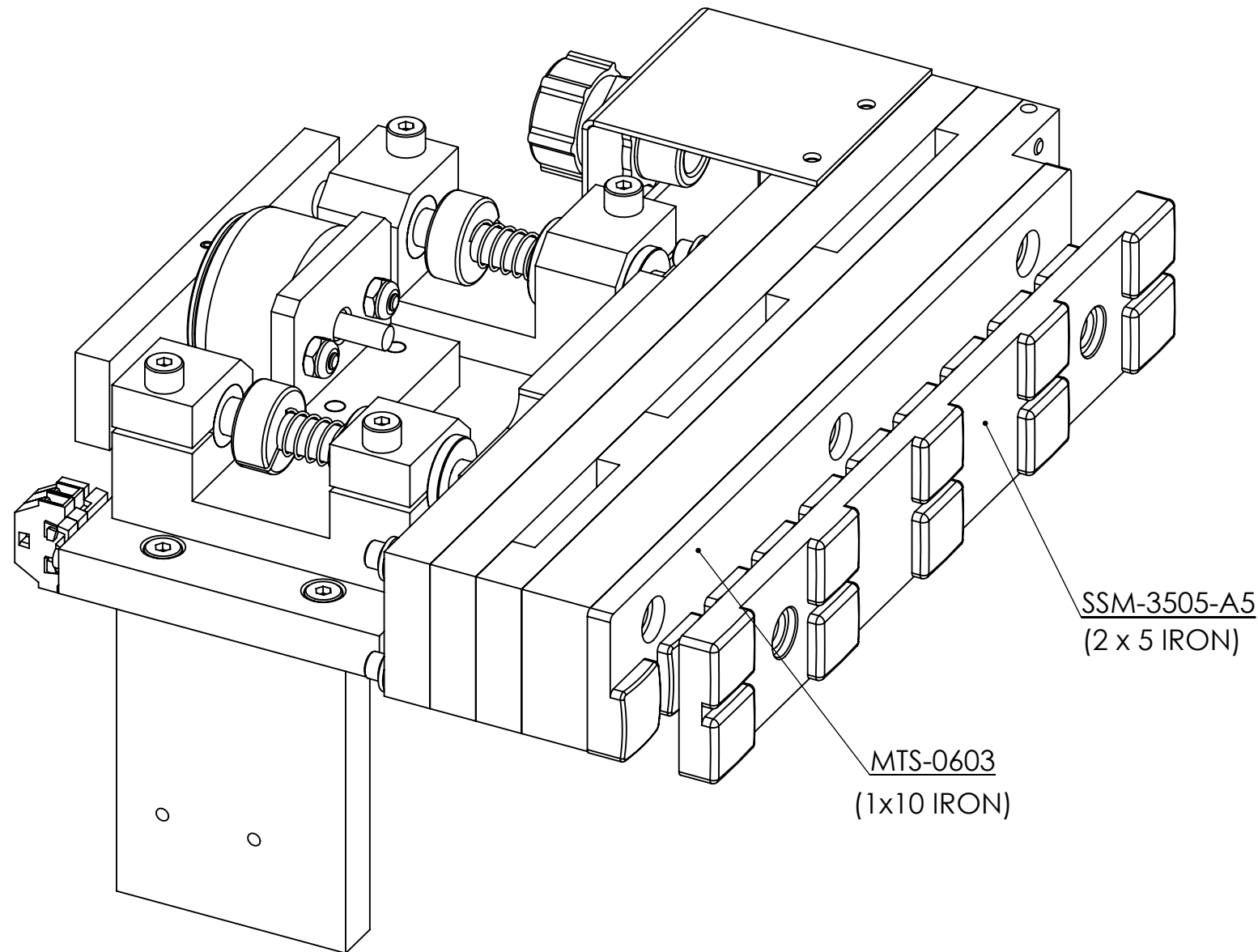

36		1/8 x 1" SPRING PIN SLOTTED	1
35		FHSCS .25-20 x 3/4" LG	4
34		SOCKET HEAD CAP SCREW	2
33		SHCS 1/4-20 x 3/4" LG	12
32		3/8 HARDENED WASHER	2
31		SHCS #8-32 X 2.0" LG.	6
30		FLAT WASHER #8	6
29		SPRING LOCK WASHER #8	6
28		SHCS 10-32 x 3/4" LG	4
27		8-32 NYLON LOCKING HEX NUT	2
26	305308	500 W STRIP HEATER	1
25	749314	BRACKET, FLEXIBLE CONDUIT	1
24	41113015	THERMOCOUPLE PLUG	1
23	41114003	CERAMIC TERMINAL BLOCK	1
22	41132074	STRAIN RELIEF	1
21	41135061	END PLATE	1
20	41135072	TERMINAL	2
19	41173507	THERMOCOUPLE - TYPE J	1
18	41178617	3/8 ID LINEAR BALL BEARING	4
17	41241004	3/8 ID CLAMPING COLLAR	2
16	41242004	COMPRESSION SPRING	2
15	41249128	3/8 ID EPDM WASHER	2
14	MTS-0603	1 X 10 STAMP IRON	1
13	MTS-0608	IRON BASE	1
12	MTS-0620	SOLENOID DRIVE BLOCK	1
11	MTS-0621	SLIDE GUIDE BLOCK	2
10	MTS-0622	SOLENOID MOUNTING PLATE	1
9	MTS-0623	SOLENOID MOUNT SUPPORT	2
8	MTS-0624	STAMP HEAD ASSY MTG PLATE	1
7	MTS-0625	SOLENOID MTG BRKT	1
6	MTS-0627	LOW PROFILE SOLENOID	1
5	SSM-3501	STAMP COVER PLATE	1
4	SSM-3502	INSULATOR	1
3	SSM-3503	HEATER RETAINER	1
2	SSM-3505-A5	STAMP IRON REF #HS11428R4	1
1	SSM-8606	GUIDE SHAFT	2
ITEM NO.	USIPN	DESCRIPTION	QTY

B	01/16/2009	ADD 749314, 41135072 & 41135061 & SHT 2 ECN 09-1001 WBE	
REV.	DATE	DESCRIPTION	APP

TOLERANCES
UNLESS OTHERWISE NOTED
.X = ±.05"
.XX = ±.015"
.XXX = ±.005"
.XXXX = ±.0005"
ANGLES = ±1/2°
FRACTIONS = ±1/64"

MATERIAL:
SEE COMPONENTS
FINISH:
NONE

ALL DIMENSIONS IN INCHES UNLESS OTHERWISE NOTED.
REMOVE ALL SHARP EDGES.
CONFORMANCE: ASME Y14.5M-1994

PRODUCT: **MTS**
SHEET: 1 OF 2

 MEYERCORD
Tax Stamping Equipment

SOLENOID STAMP HEAD ASSEMBLY

DESIGN: WBE DRAWN: 03/28/08
SCALE: 1:1.5 APPRD: **MTS-06** **B**
DWG DWG REV

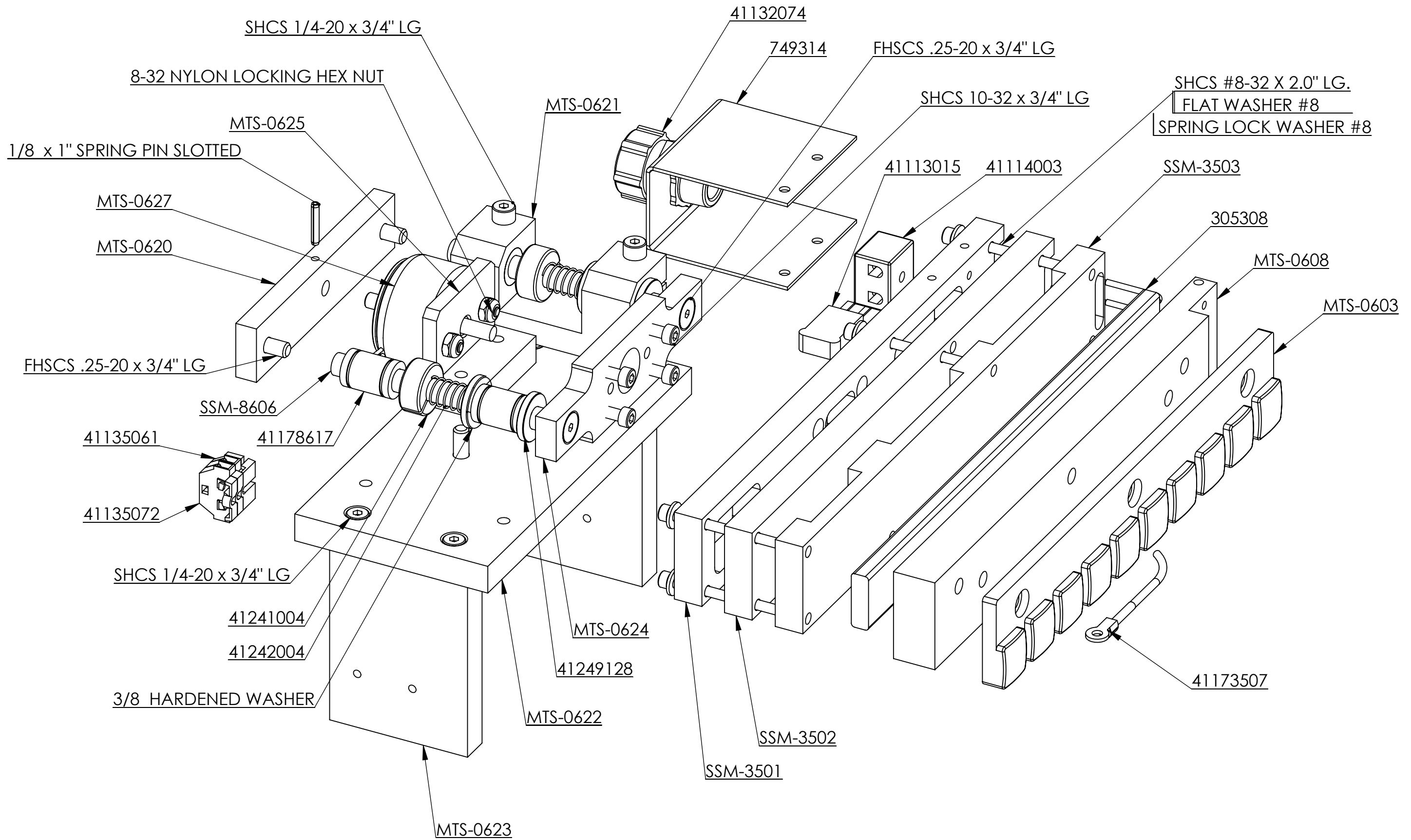

TOLERANCES UNLESS OTHERWISE NOTED .X = ±.05" .XX = ±.015" .XXX = ±.005" .XXXX = ±.0005 ANGLES = ±1/2° FRACTIONS = ±1/64"	MATERIAL: SEE COMPONENTS	PRODUCT: MTS SHEET: 2 OF 2			
	FINISH: NONE	SOLENOID STAMP HEAD ASSEMBLY			
ALL DIMENSIONS IN INCHES UNLESS OTHERWISE NOTED. REMOVE ALL SHARP EDGES. CONFORMANCE: ASME Y14.5M-1994		DESIGN: WBE SCALE: 1:1.5	DRAWN: 03/28/08 APPRD:	MTS-06 DWG	B DWG REV

REV.	DATE	DESCRIPTION	APP
B	01/16/2009	ADD 749314, 41135072 & 41135061 & SHT 2 ECN 09-1001	WBE

© THIS DOCUMENT AND THE INFORMATION CONTAINED HEREIN IS PROPRIETARY AND MAY NOT BE REPRODUCED OR OTHERWISE USED WITHOUT THE EXPRESSED WRITTEN CONSENT OF THE MEYERCORD CO.

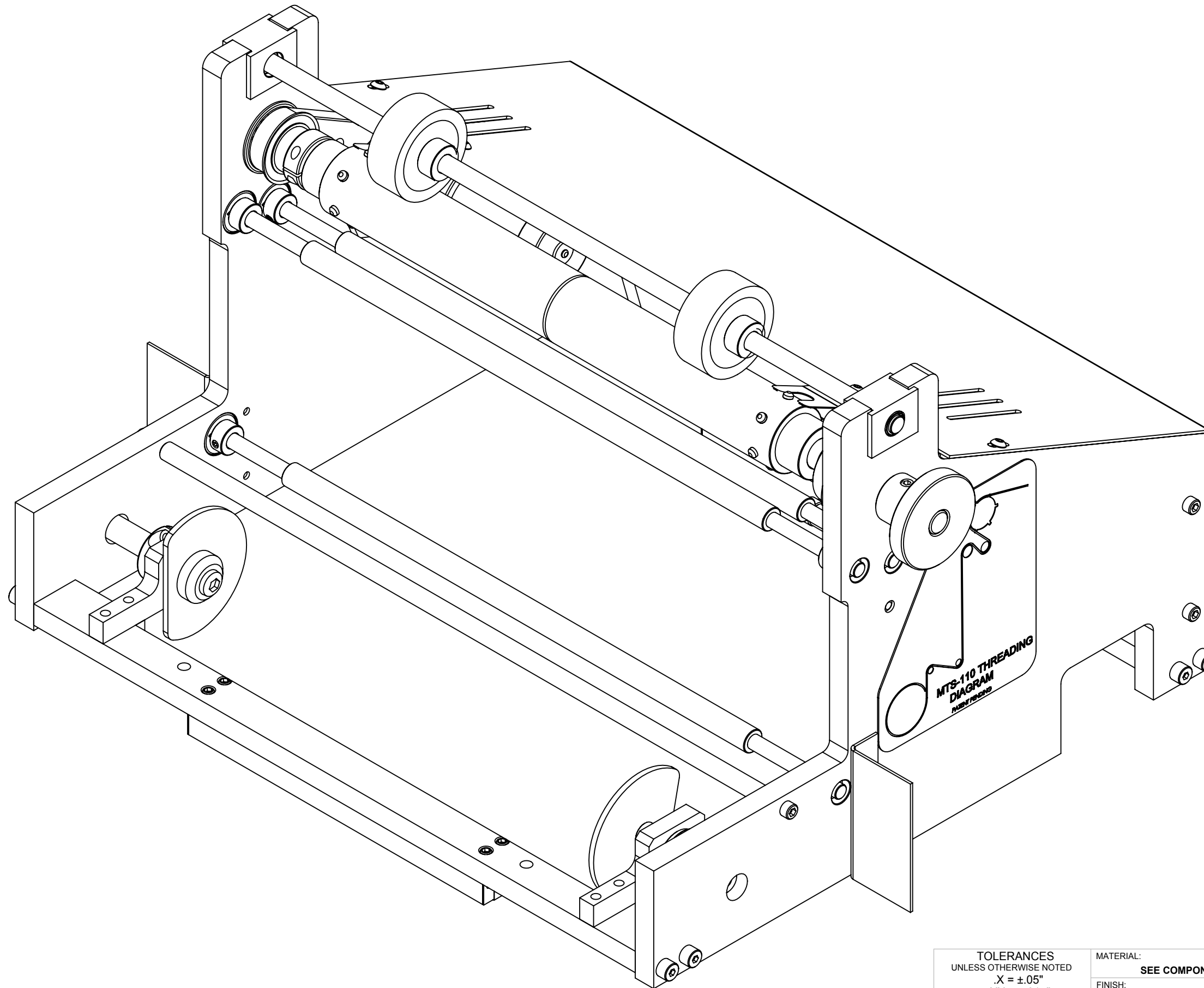

65		SHCS 1/4-20 x 3/4" LG	8
64		SHCS #10-32 X .75" LG.	14
63		Screw.SHBH.1/4-20 x 1	1
62		LOCK WASHER 1/4"	1
61		FLAT WASHER 1/4"	2
60		8-32 x 3/4 BHCS	8
59		8-32 NYLON LOCKING HEX NUT	4
58		6-32 x 3/8 LG SHCS	8
57		10-32 X 1/2 BUTTON HEAD SCR	6
56		1/4 ID HARDENED WASHER	1
55		1/4-28 HEX NUT	1
54		1/4-20 x 1 1/4 BUTT HD CAP SCR	3
53		#8-32 X 3/8 BUTT HD SCR	4
52		# 6-32 x 3/8 BUTT HD SCR	2
51	108058	THRUST WASHER .25 x .63 x .03	1
50	108168	BALL BEARING	6
49	109543	SET SCR COLLAR 5/16 ID	5
48	162805	BRONZE FLANGE BEARING	2
47	173420	FEED PAWL ROLLER	1
46	177237	EXT RETAINER RING 1/4 ID	1
45	177259	EXT RETAINER RING 5/16 ID	1
44	177787	MACHINED GROOVED GUIDE ROLLER	1
43	177886	PLAIN STAMP GUIDE ROLLER.	2
42	179261	1/4-20 X 1/4 CUP SET SCR	1
41	182484	CARRIAGE SPACER	1
40	183155	FEED ROLL PAWL SPRING RETAINER	1
39	187753	THRUST WASHER .51 ID	1
38	188006	STAMP FEED ROLLER HAND WHEEL.	1
37	198764	EXTENSION SPRING	1
36	202790	ROLLER GUIDE ASSEMBLY	1
35	202867	PAWL FEED ASSEMBLY	1
34	202878	PEG ROLLER ASSEMBLY	1
33	744188	SPRING CORE HOLDER ASSY	1
32	744716	SHAFT	1
31	41041033	GEAR MOTOR	1
30	41124043	PROXIMITY SENSOR	1
29	41124047	RA FEMALE - STRAIGHT MALE	1
28	41201041	1/2 ID BEARING	2
27	41203019	BRONZE WASHER	1
26	41203033	1/2 ID THRUST WASHER	1
25	41204011	CAM FOLLOWER	1
24	41205005	CLUTCH AND BEARING	1
23	41206008	BALL SLIDE ASSEMBLY	2
22	41212009	TIMING BELT PULLEY	1
21	41215006	3/8 WIDE XL TIMING BELT	1
20	41241006	1/2" ID CLAMPING COLLAR	3
19	41242045	CONICAL SPRING	1
18	MTS-0701	LH SIDE SUPPORT	1
17	MTS-0702	RH SIDE SUPPORT	1
16	MTS-0703	FRONT SLIDE SUPPORT	1
15	MTS-0704	SUPPORT GUSSET	2
14	MTS-0705	BACK COVER	1
13	MTS-0706	BACK SLIDE SUPPORT	1
12	MTS-0709	PROXIMITY SWITCH TARGET	1
11	MTS-0710	GUARD PLATE	2
10	MTS-0711	14.5 DEG PRESURE ANGLE RACK	1
9	MTS-0712	MOTOR MTG PLATE	1
8	MTS-0714	MOTOR MOUNT SPACER	3
7	MTS-0715	SWITCH MOUNTING PLATE	1
6	MTS-0718	XL TIMING BELT PULLEY	1
5	MTS-0720	BEARING MTG PLATE	2
4	MTS-0722	RACK RISER	1
3	MTS-0723	STAMP ROLL STRIPPER PLATE	2
2	MTS-0725	ROLL HOLDER	1
1	MTS-0730	THREADING DIAGRAM	1
ITEM NO.	USIPN	DESCRIPTION	QTY

TOLERANCES
UNLESS OTHERWISE NOTED
.X = ±.05"
.XX = ±.015"
.XXX = ±.005"
.XXXX = ±.0005
ANGLES = ±1/2°
FRACTIONS = ±1/64"

MATERIAL:
SEE COMPONENTS
FINISH:
NONE

ALL DIMENSIONS IN INCHES UNLESS OTHERWISE NOTED.
REMOVE ALL SHARP EDGES.
CONFORMANCE: ASME Y14.5M-1994

PRODUCT: **MTS**
SHEET: **1 OF 4**

 **MEYERCORD**
Tax Stamping Equipment

CARRIAGE ASSEMBLY

DESIGN: WBE DRAWN: 01/28/08
SCALE: 1:2 APPRD: DWG **MTS-07** **C**

REV.	DATE	DESCRIPTION	APP
C	01/16/2009	OMIT MTS-0724 & 0721, ADD MTS-0730 ECN 09-1001	WBE

© THIS DOCUMENT AND THE INFORMATION CONTAINED HEREIN IS PROPRIETARY AND MAY NOT BE REPRODUCED OR OTHERWISE USED WITHOUT THE EXPRESSED WRITTEN CONSENT OF THE MEYERCORD CO.

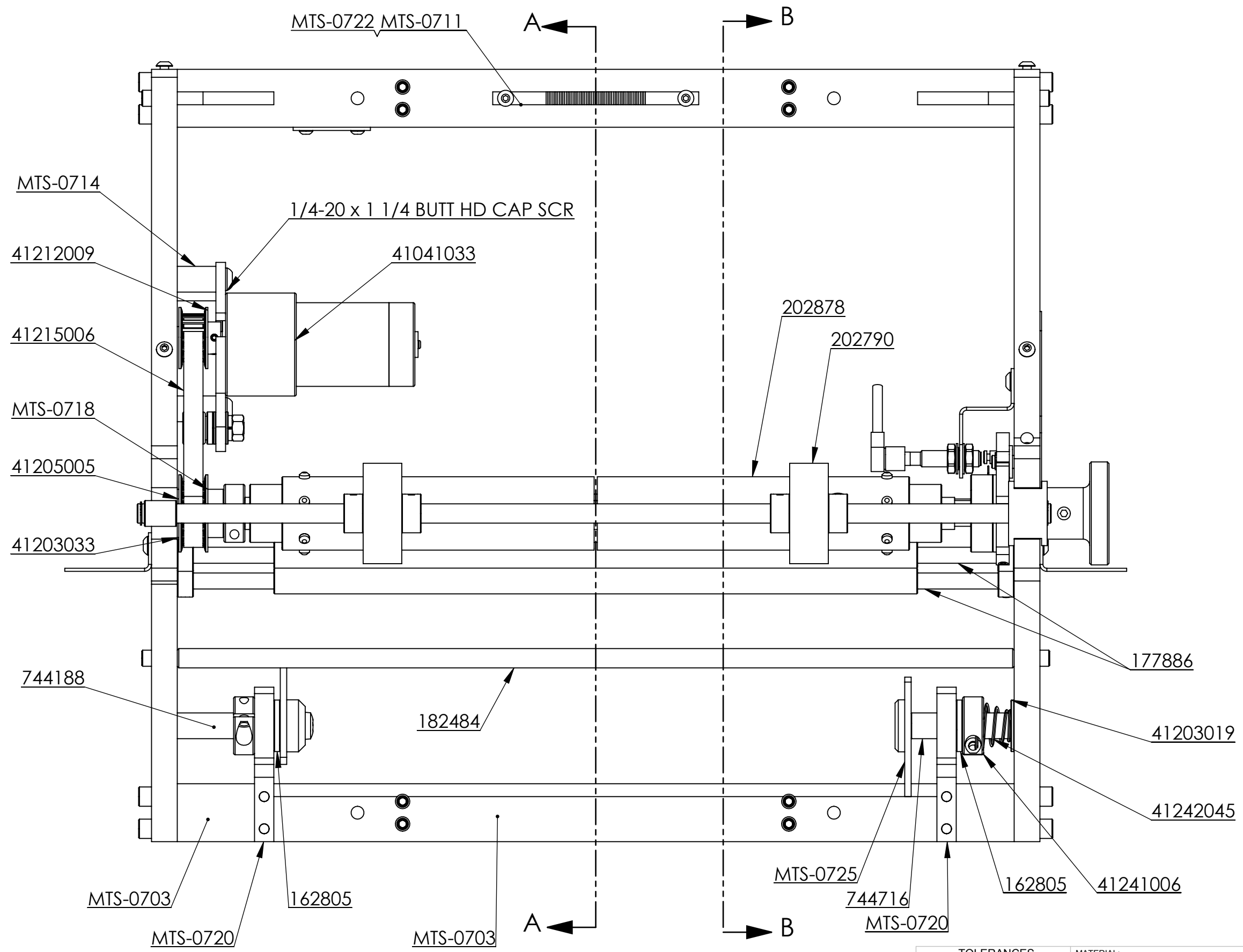

DRAWING NOTES
 1 STAMP WITH PART NUMBER AND REVISION APPROX. WHERE SHOWN. FOR SMALLER PARTS, TAG WITH PART NUMBER.

TOLERANCES UNLESS OTHERWISE NOTED .X = ±.05" .XX = ±.015" .XXX = ±.005" .XXXX = ±.0005" ANGLES = ±1/2° FRACTIONS = ±1/64"	MATERIAL: SEE COMPONENTS
	FINISH: NONE
ALL DIMENSIONS IN INCHES UNLESS OTHERWISE NOTED. REMOVE ALL SHARP EDGES. CONFORMANCE: ASME Y14.5M-1994	

PRODUCT:	MTS
SHEET:	2 OF 4



CARRIAGE ASSEMBLY

C	01/16/2009	OMIT MTS-0724 & 0721, ADD MTS-0730 ECN 09-1001	WBE
REV.	DATE	DESCRIPTION	APP

© THIS DOCUMENT AND THE INFORMATION CONTAINED HEREIN IS PROPRIETARY AND MAY NOT BE REPRODUCED OR OTHERWISE USED WITHOUT THE EXPRESSED WRITTEN CONSENT OF THE MEYERCORD CO.

DESIGN:	WBE	DRAWN:	01/28/08	MTS-07 DWG	C DWG REV
SCALE:	1:2	APPRD:			

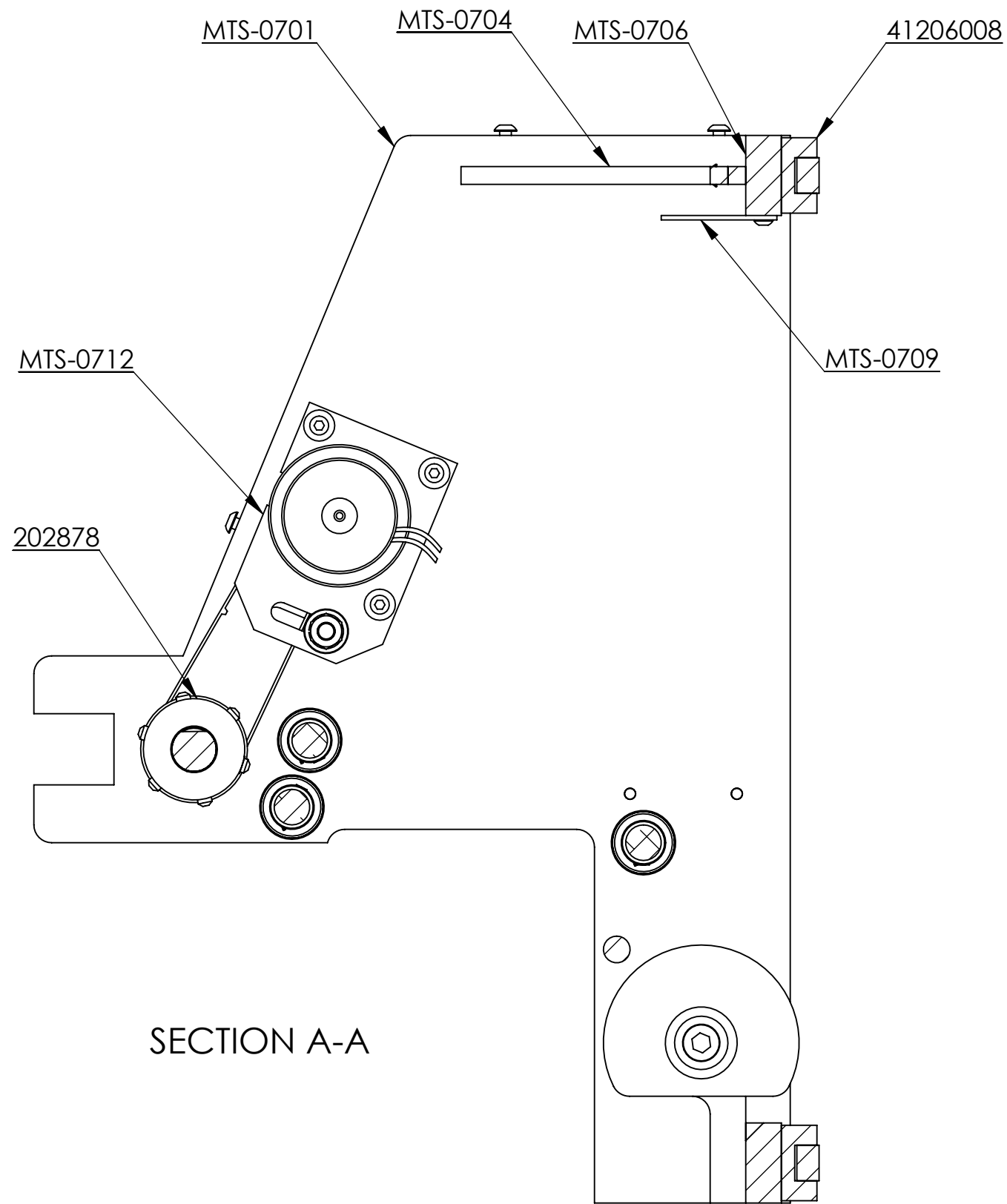

SECTION A-A

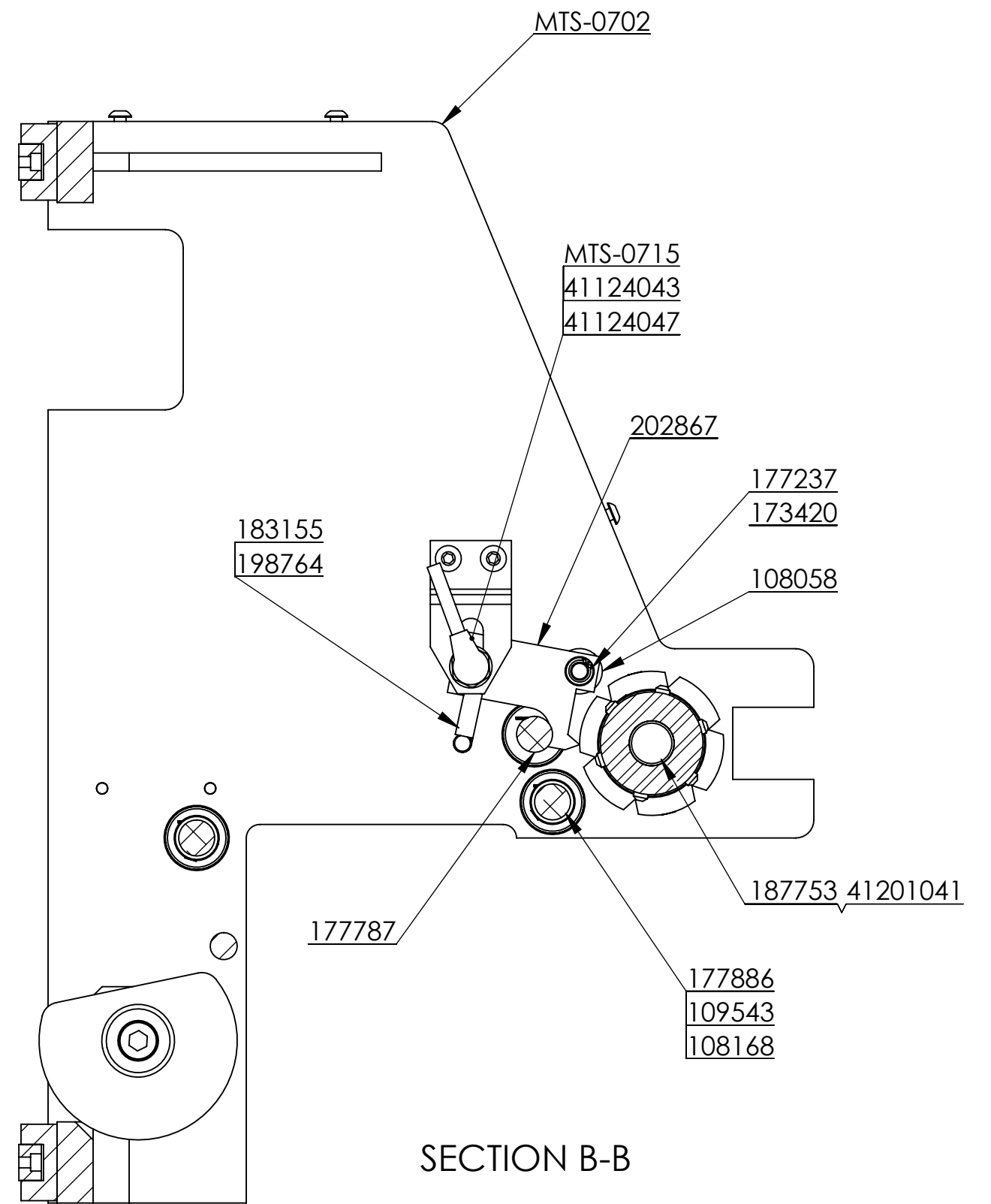

SECTION B-B

REV.	DATE	DESCRIPTION	APP
C	01/16/2009	OMIT MTS-0724 & 0721, ADD MTS-0730 ECN 09-1001	WBE

TOLERANCES
UNLESS OTHERWISE NOTED
.X = ±.05"
.XX = ±.015"
.XXX = ±.005"
.XXXX = ±.0005
ANGLES = ±1/2°
FRACTIONS = ±1/64"

MATERIAL:
SEE COMPONENTS

FINISH:
NONE

ALL DIMENSIONS IN INCHES UNLESS OTHERWISE NOTED.
REMOVE ALL SHARP EDGES.
CONFORMANCE: ASME Y14.5M-1994

PRODUCT: MTS
SHEET: 3 OF 4

 **MEYERCORD**
Tax Stamping Equipment

CARRIAGE ASSEMBLY

DESIGN: WBE DRAWN: 01/28/08
SCALE: 1:2 APPRD: **MTS-07** **C**
DWG REV

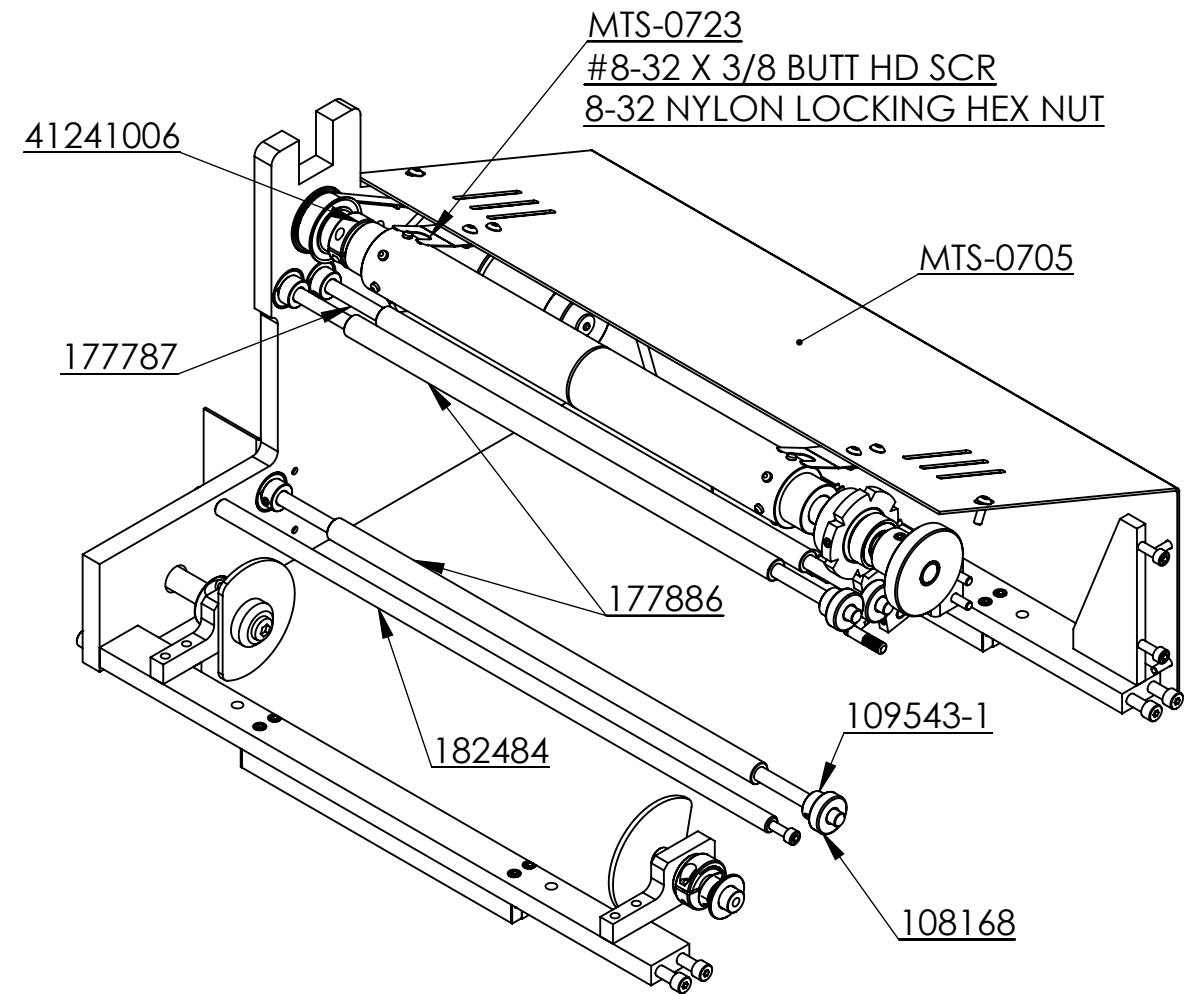
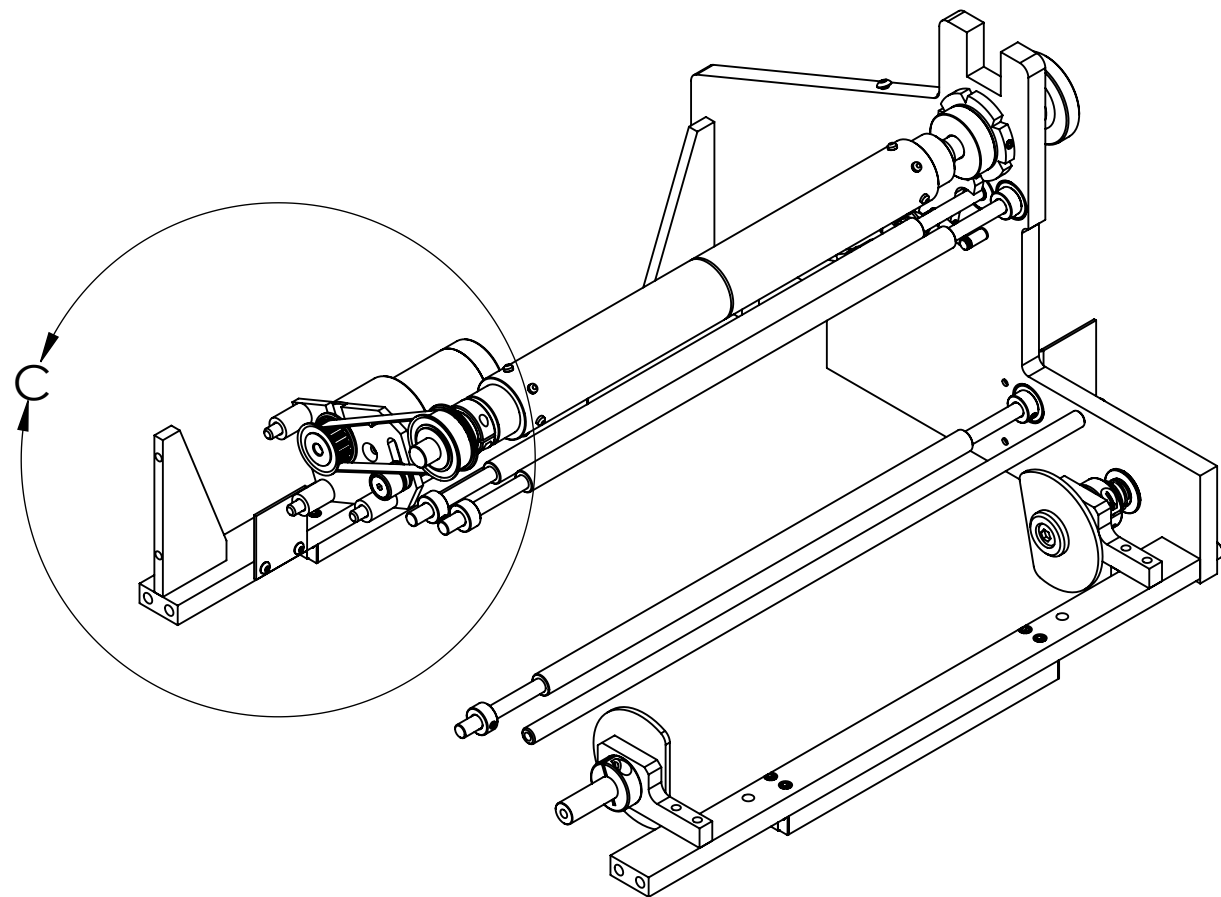

MTS-0723
#8-32 X 3/8 BUTT HD SCR
8-32 NYLON LOCKING HEX NUT

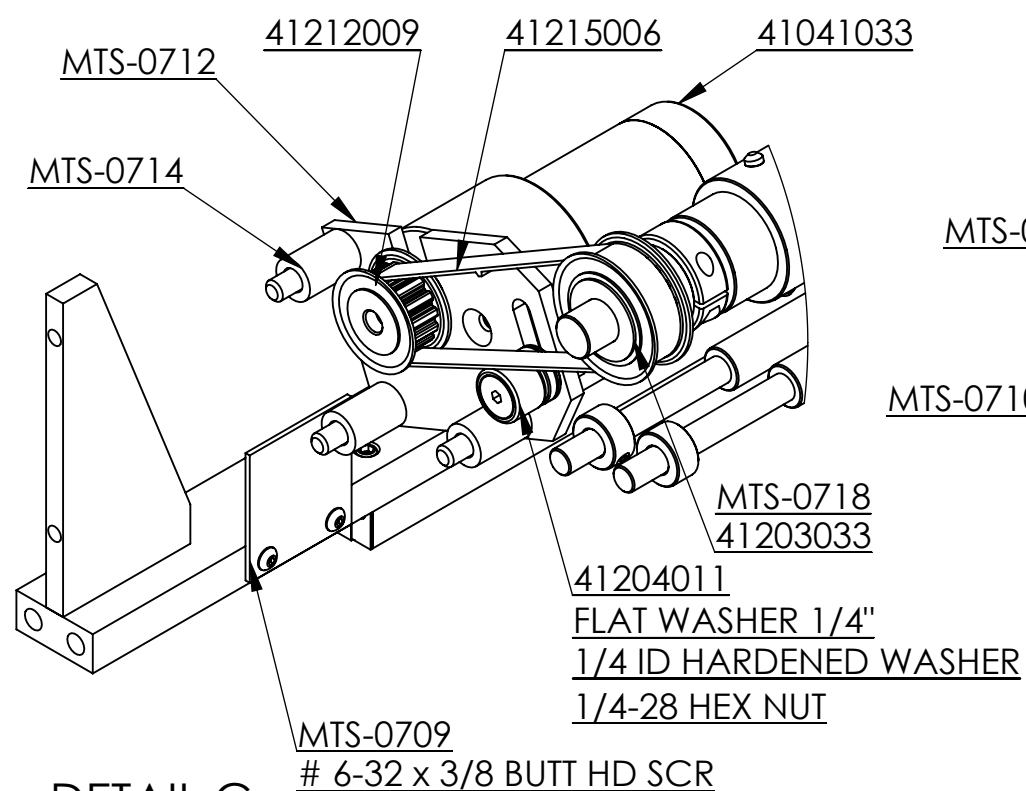

41204011
FLAT WASHER 1/4"
1/4 ID HARDENED WASHER
1/4-28 HEX NUT

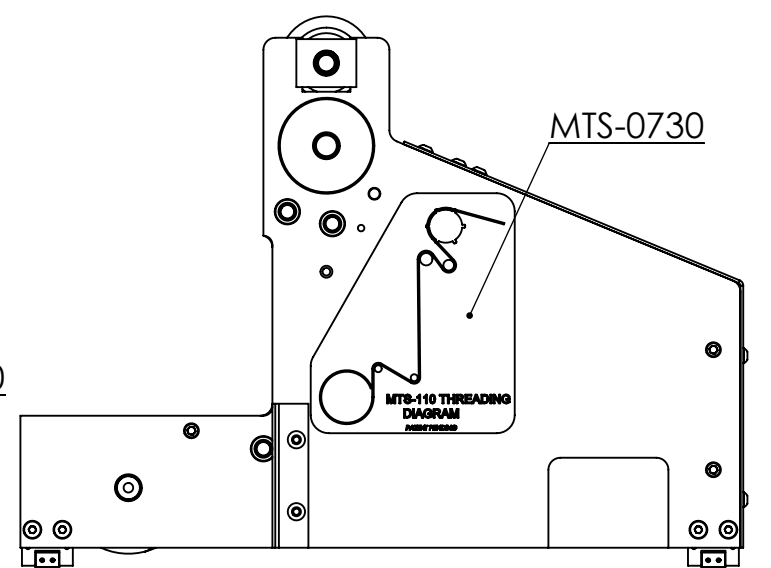
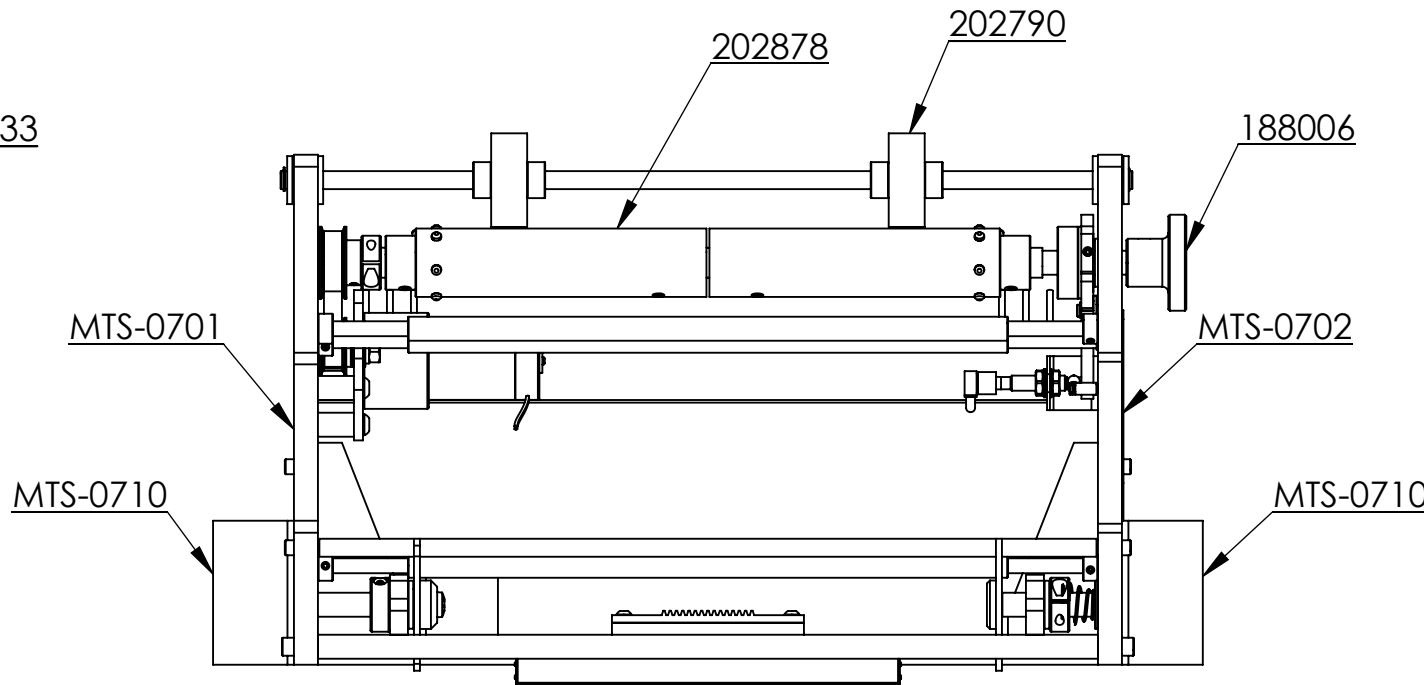

DETAIL C
SCALE 1 : 2

REV.	DATE	DESCRIPTION	APP
C	01/16/2009	OMIT MTS-0724 & 0721, ADD MTS-0730 ECN 09-1001	WBE
			APP

TOLERANCES
UNLESS OTHERWISE NOTED
.X = ±.05"
.XX = ±.015"
.XXX = ±.005"
.XXXX = ±.0005
ANGLES = ±1/2°
FRACTIONS = ±1/64"

MATERIAL:
SEE COMPONENTS

FINISH:
NONE

ALL DIMENSIONS IN INCHES UNLESS OTHERWISE NOTED.
REMOVE ALL SHARP EDGES.
CONFORMANCE: ASME Y14.5M-1994

PRODUCT: MTS
SHEET: 4 OF 4

 MEYERCORD
Tax Stamping Equipment

CARRIAGE ASSEMBLY

DESIGN: WBE DRAWN: 01/28/08
SCALE: 1:4 APPRD: MTS-07
DWG REV: C

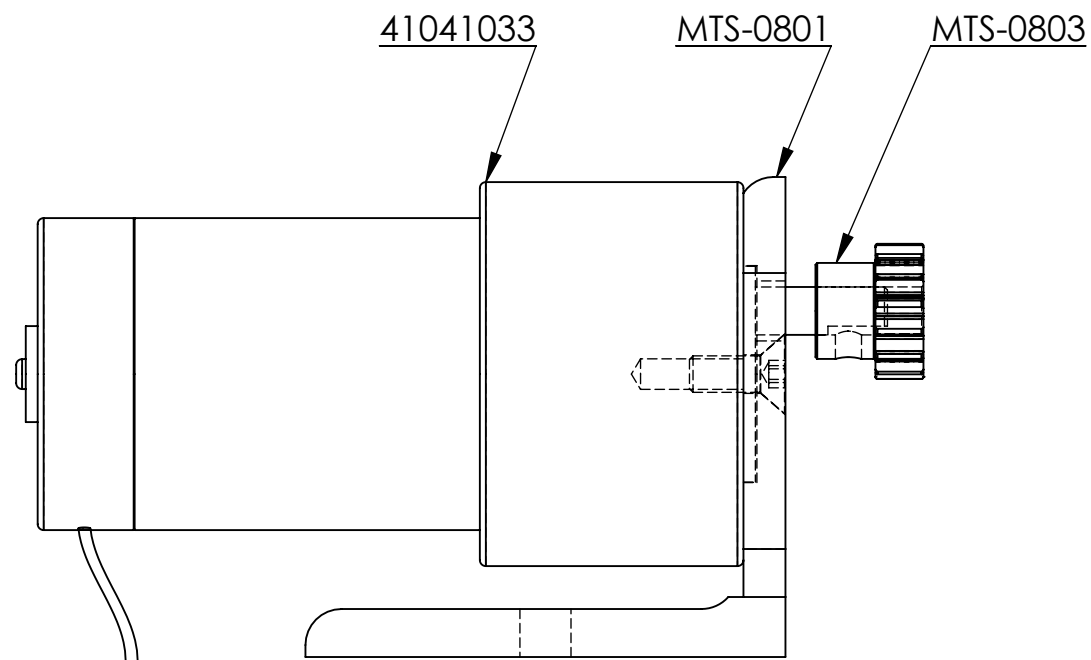
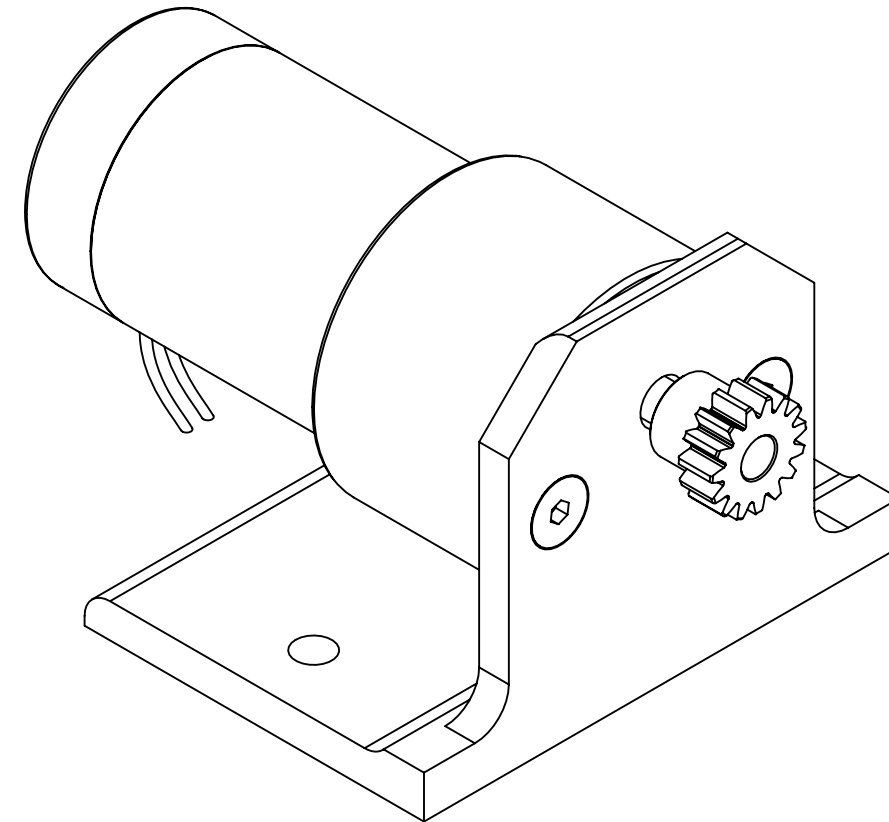
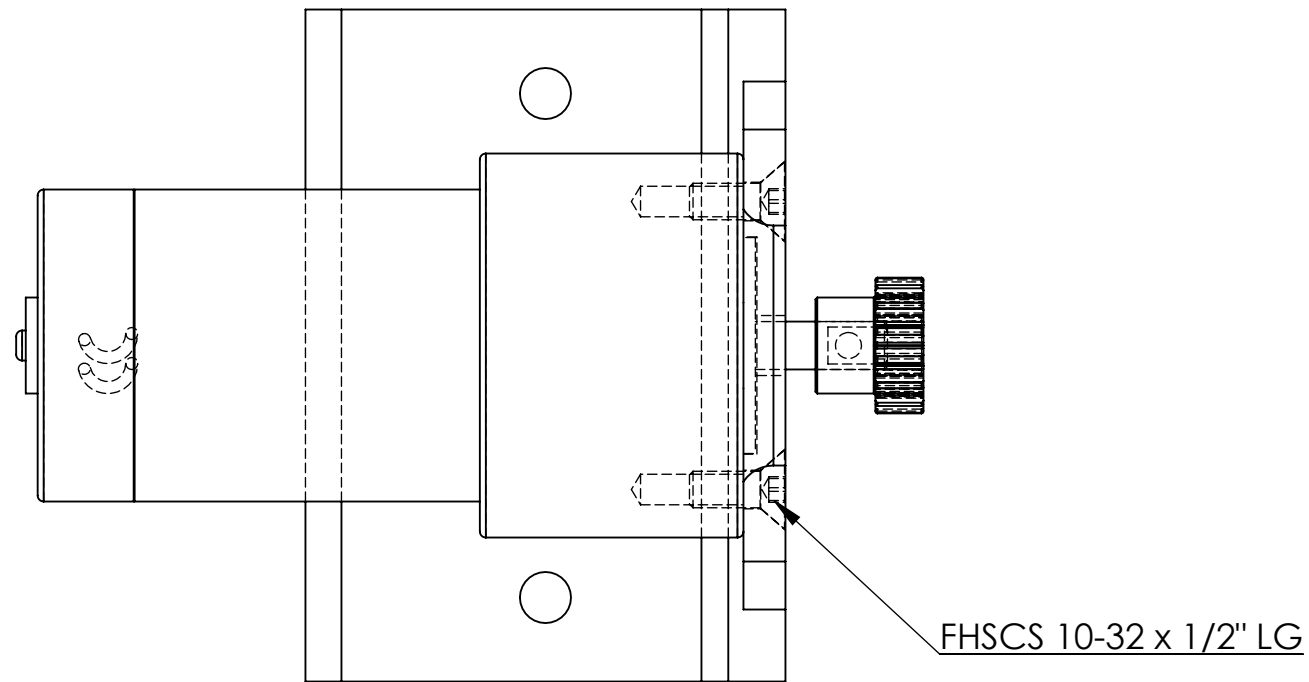

4		FHSCS 10-32 x 1/2" LG	2
3	41041033	GEAR MOTOR	1
2	MTS-0801	MOTOR MOUNTING BRACKET	1
1	MTS-0803	SPUR GEAR	1
ITEM NO.	USIPN	DESCRIPTION	QTY

TOLERANCES UNLESS OTHERWISE NOTED .X = ±.05" .XX = ±.015" .XXX = ±.005" .XXXX = ±.0005" ANGLES = ±1/2° FRACTIONS = ±1/64"		MATERIAL: SEE COMPONENT DWGS	PRODUCT: MTS SHEET: 1 OF 1
		FINISH: NONE	
		ALL DIMENSIONS IN INCHES UNLESS OTHERWISE NOTED. REMOVE ALL SHARP EDGES. CONFORMANCE: ASME Y14.5M-1994	

A	09/11/2008	UPDATE ASSEMBLY TO REFLECT COMPONENT CHANGES ECN 08-1142	WBE
REV.	DATE	DESCRIPTION	APP

© THIS DOCUMENT AND THE INFORMATION CONTAINED HEREIN IS PROPRIETARY AND MAY NOT BE REPRODUCED OR OTHERWISE USED WITHOUT THE EXPRESSED WRITTEN CONSENT OF THE MEYERCORD CO.

DESIGN: WBE	DRAWN: 03/28/08	MTS-08 DWG	A DWG REV
SCALE: 1:1	APPD:		

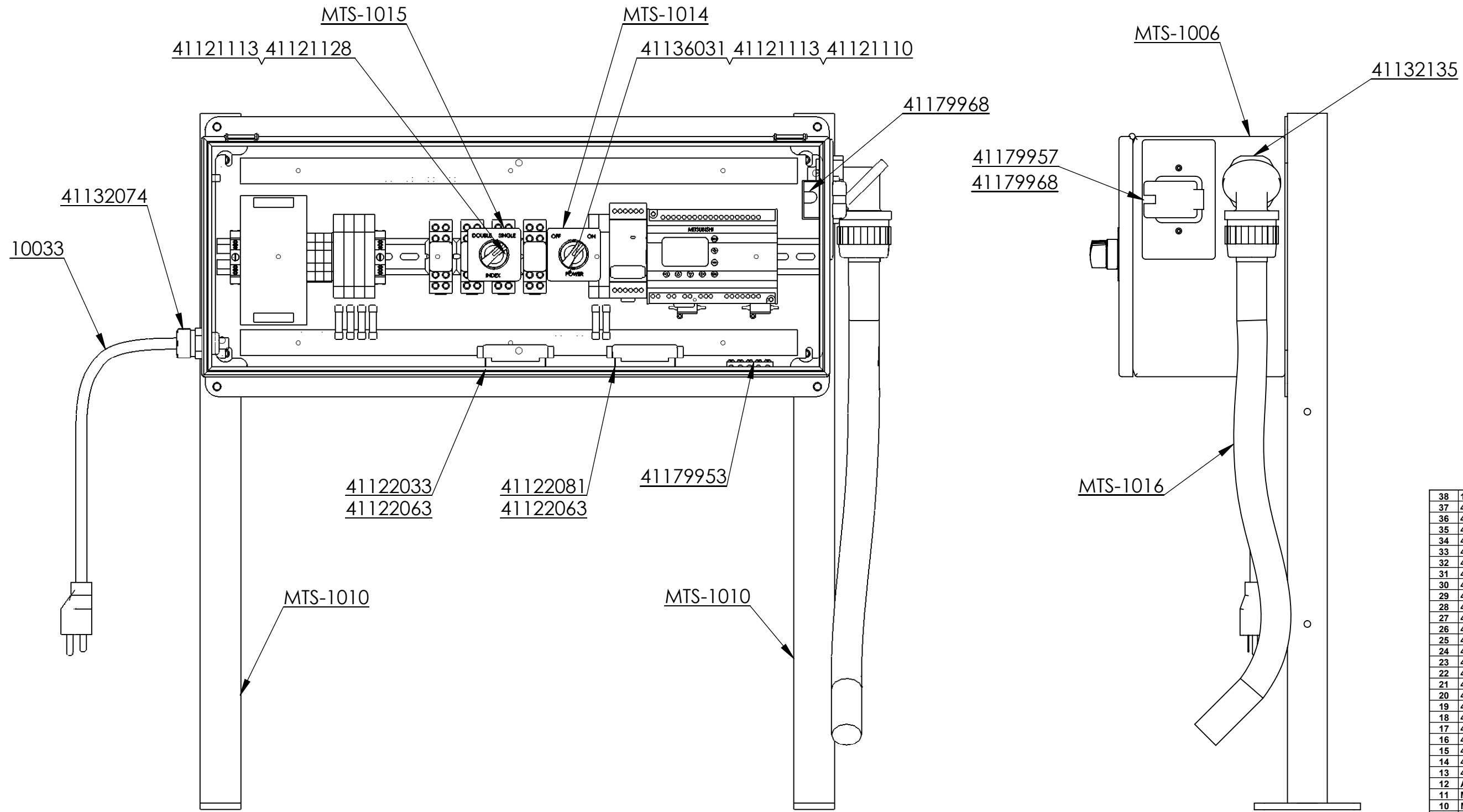

ITEM NO.	USIPN	DESCRIPTION	QTY
38	10033	13A POWER CORD	1
37	41101056	ALPHA SERIES PLC	1
36	41101057	THERMOCOUPLE INPUT MODULE	1
35	41102060	10 WATT, 0.5 OHM RESISTOR	2
34	41121110	GREEN POWER SELECTOR SWITCH	1
33	41121113	SWITCH CONTACTOR BASE	2
32	41121128	BLACK SELECTOR SWITCH	1
31	41122025	CONTROL RELAY	4
30	41122033	HEAT SOLID STATE RELAY	1
29	41122059	RELAY BASE	4
28	41122063	RELAY COVER	2
27	41122081	SOLID STATE RELAY	1
26	41132074	STRAIN RELIEF	1
25	41132135	1" MULTI-POSITION FITTING	1
24	41135050	TERMINAL BLOCK (5MM)	7
23	41135054	FUSE BLOCK	6
22	41135056	TERMINAL BLOCK (6mm)	3
21	41135060	END STOP	3
20	41135083	TERMINAL BLOCK END PLATE	1
19	41135084	TERMINAL BLOCK END PLATE	1
18	41136031	SELECTOR SWITCH LED	1
17	41152011	POWER SUPPLY (24V dc) 5A	1
16	41179953	5 HOLE GROUND BAR	1
15	41179957	ELECTRICAL BOX COVER	1
14	41179968	15 A 125V SINGLE PLUG RECPT	1
13	41249131	MALE FEMALE STANDOFF	2
12	AGC-1	FAST-ACTING FUSE	1
11	MDA-10	TIME-DELAY FUSE	1
10	MDA-4	TIME-DELAY FUSE	1
9	MDA-5	TIME-DELAY FUSE	3
8	MTS-1006	ELECTRICAL ENCLOSURE	1
7	MTS-1007	ENCLOSURE PANEL	1
6	MTS-1008	GREY PVC WIRE DUCT	2
5	MTS-1009	22.75 LG DIN RAIL	1
4	MTS-1010	ELEC ENCLOSURE SUPPORT	2
3	MTS-1014	POWER LABEL	1
2	MTS-1015	SELECTOR LABEL	1
1	MTS-1016	1" FLEXIBLE CONDUIT(41137002)	1

TOLERANCES
UNLESS OTHERWISE NOTED
.X = ±.05"
.XX = ±.015"
.XXX = ±.005"
.XXXX = ±.0005
ANGLES = ±1/2°
FRACTIONS = ±1/64"

MATERIAL:
FINISH:

ALL DIMENSIONS IN INCHES UNLESS OTHERWISE NOTED.
REMOVE ALL SHARP EDGES.
CONFORMANCE: ASME Y14.5M-1994

PRODUCT: **MTS**
SHEET: 1 OF 2

MEYERCORD
Tax Stamping Equipment

ELECTRICAL PANEL ASSY

REV.	DATE	DESCRIPTION	APP
B	01/16/2009	UPDATE COMPONENTS & LAYOUT ECN 09-1001	WBE

DESIGN: WBE
SCALE: 1:4

DRAWN: 04/07/08
APPRD:

MTS-100
DWG

B
DWG REV

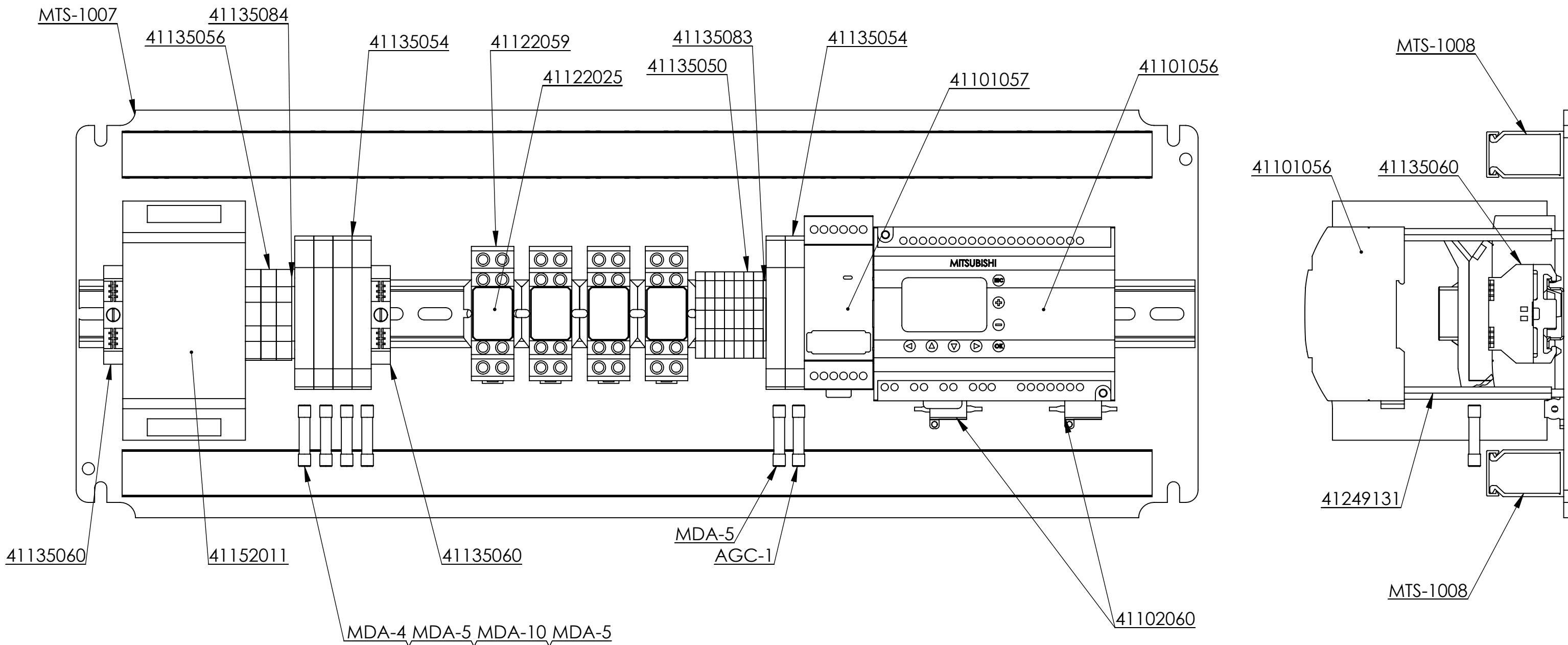

PANEL LAYOUT

REV.	DATE	DESCRIPTION	APP
B	01/16/2009	UPDATE COMPONENTS & LAYOUT ECN 09-1001	WBE

TOLERANCES
UNLESS OTHERWISE NOTED
.X = ±.05"
.XX = ±.015"
.XXX = ±.005"
.XXXX = ±.0005"
ANGLES = ±1/2°
FRACTIONS = ±1/64"

MATERIAL:

FINISH:

ALL DIMENSIONS IN INCHES UNLESS OTHERWISE NOTED.
REMOVE ALL SHARP EDGES.
CONFORMANCE: ASME Y14.5M-1994

PRODUCT: MTS			
SHEET: 2 OF 2			
ELECTRICAL PANEL ASSY			
DESIGN: WBE	DRAWN: 04/07/08	MTS-100	B
SCALE: 1:2	APPRD:		

© THIS DOCUMENT AND THE INFORMATION CONTAINED HEREIN IS PROPRIETARY AND MAY NOT BE REPRODUCED OR OTHERWISE USED WITHOUT THE EXPRESSED WRITTEN CONSENT OF THE MEYERCORD CO.

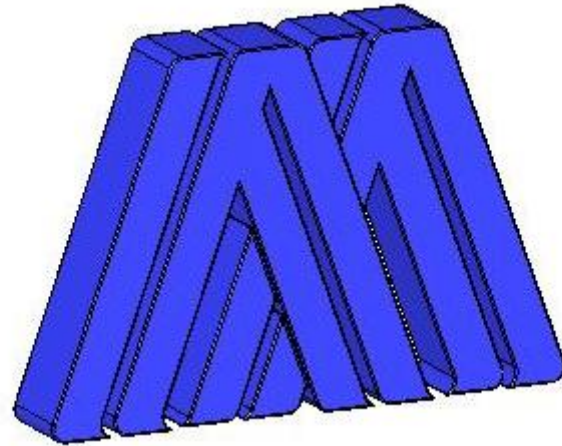

**MEYERCORD TAX STAMPING
EQUIPMENT**

Manufactured by United Silicone an ITW company

Electrical Drawings
(Attachment 2)

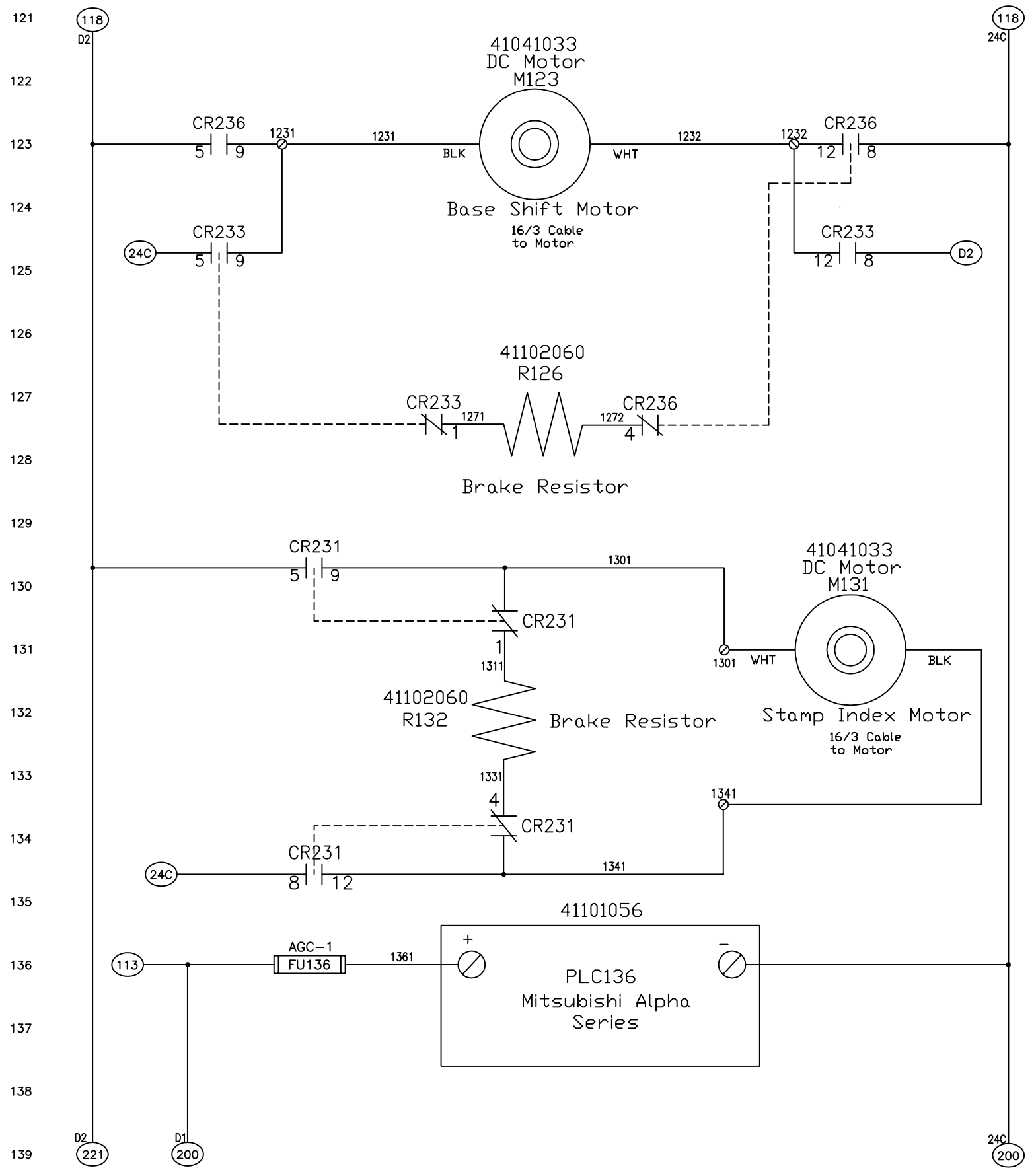
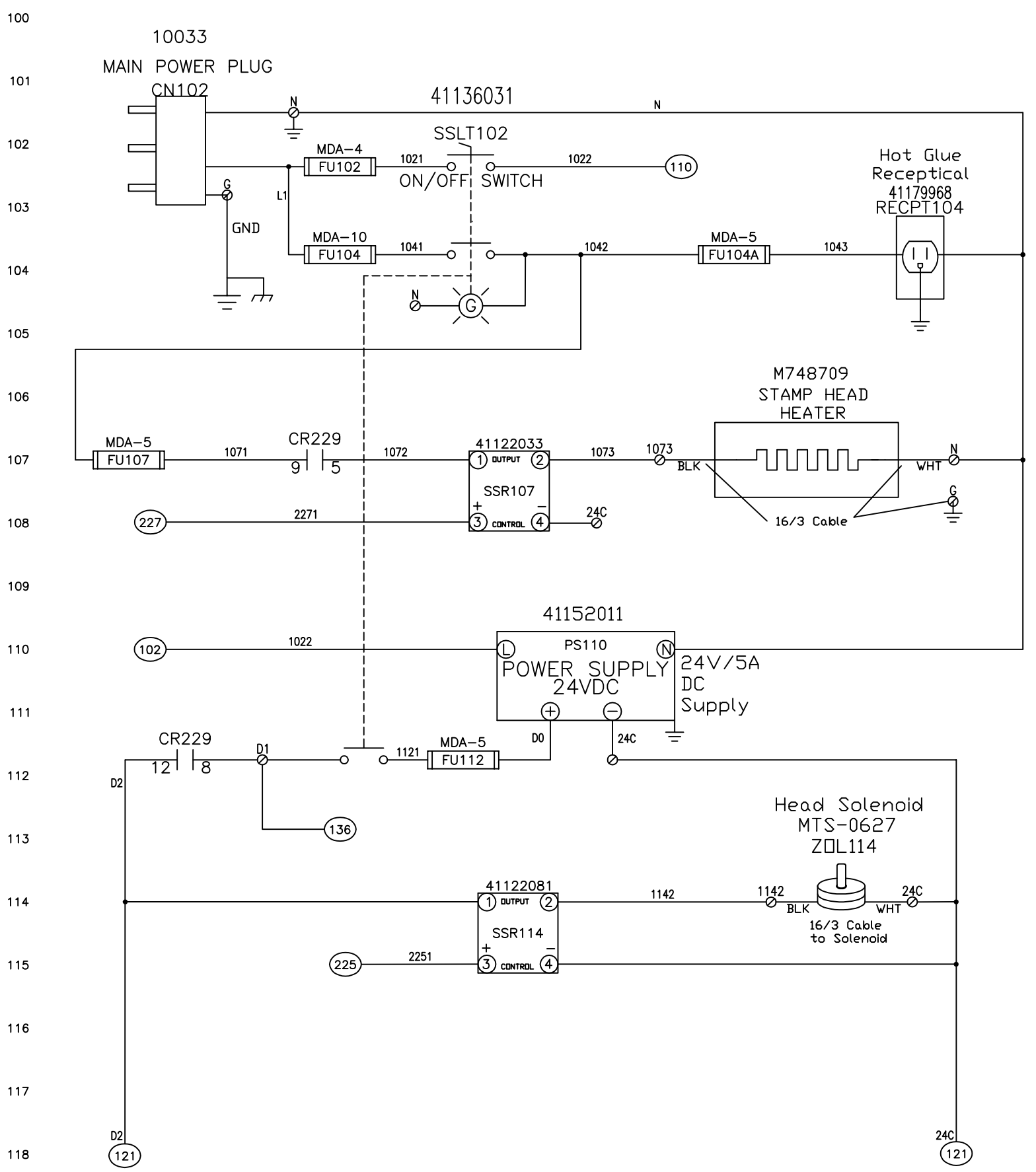

REV	DATE	DESCRIPTION	APP	REV	DATE	DESCRIPTION	APP
<small>THIS DOCUMENT AND THE INFORMATION CONTAINED HEREIN IS PROPRIETARY AND MAY NOT BE REPRODUCED OR OTHERWISE USED WITHOUT THE EXPRESSED WRITTEN CONSENT OF THE MEYERCORD CO.</small>							

TOLERANCES
 UNLESS OTHERWISE NOTED
 .X = ±.05"
 .XX = ±.015"
 .XXX = ±.005"
 .XXXX = ±.0005
 ANGLES = ±1/2°
 FRACTIONS = ±1/64"

MATERIAL:
 FINISH:
 ALL DIMENSIONS IN INCHES UNLESS OTHERWISE NOTED
 REMOVE ALL SHARP EDGES.
 CONFORMANCE: ASME Y14.5M-1994

PRODUCT SHEET: **1 of 2**
 MEYERCORD REVENUE
 an IBM company
 475 Village Drive
 Carol Stream, Illinois 60188
Manual Tax Machine
 Main & Motor Power
 REVISION: **1.00**
 DESIGN: **EKS** DRAWN: **1/20/09**
 SCALE: **1:1** APPR: **EKS** **MTS-110**

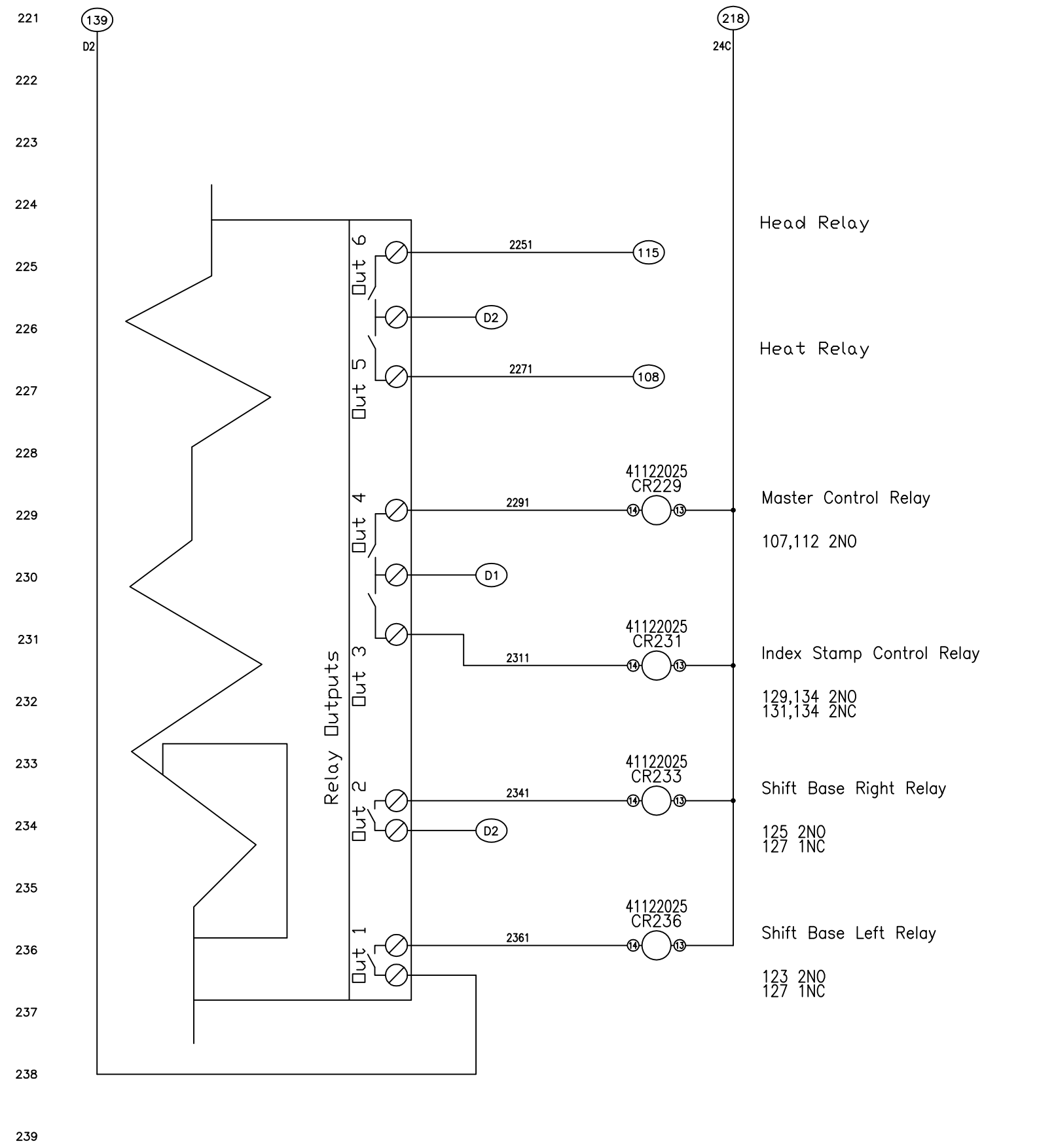
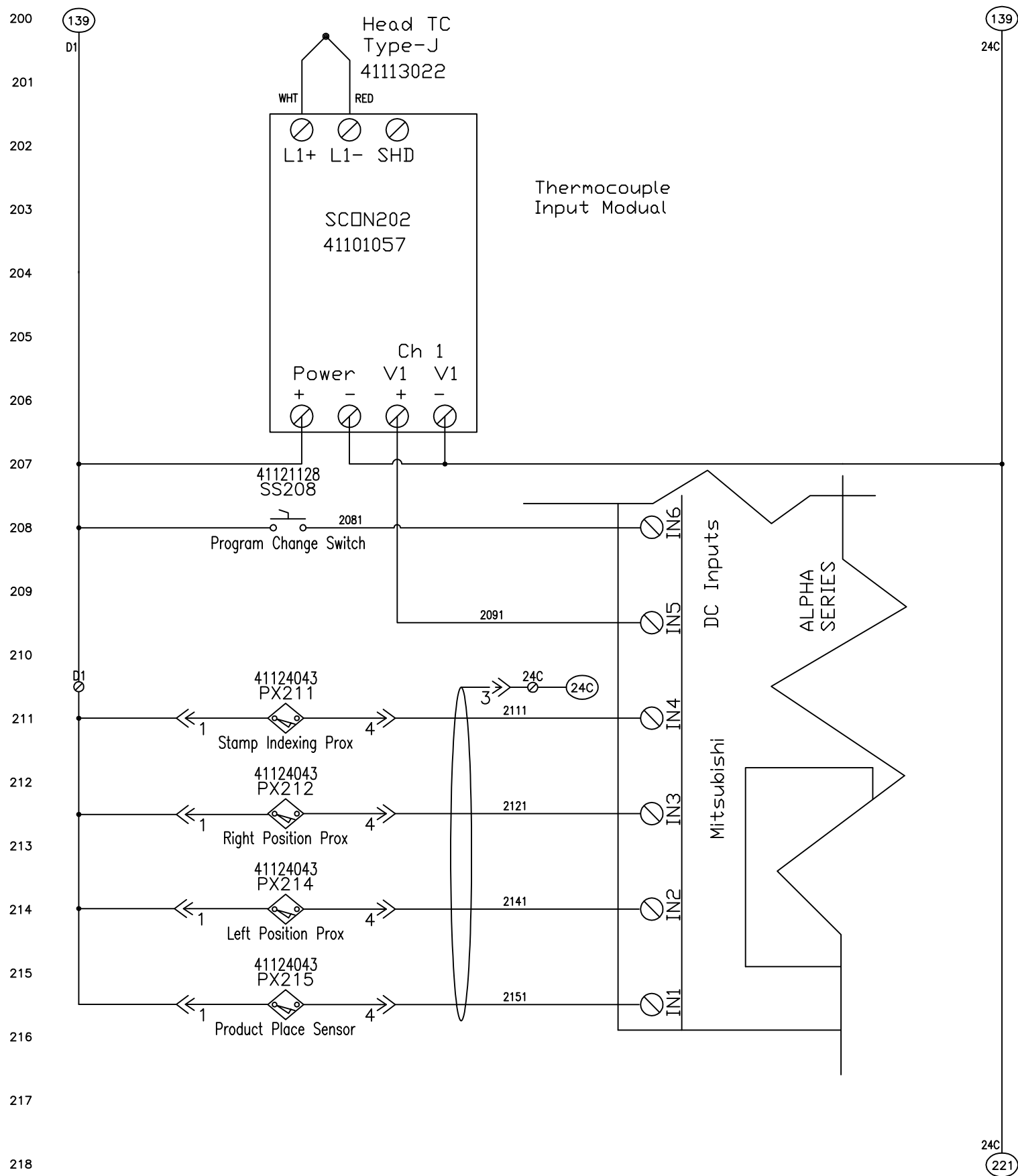

REV	DATE	DESCRIPTION	APP	REV	DATE	DESCRIPTION	APP
1							

THIS DOCUMENT AND THE INFORMATION CONTAINED HEREIN IS PROPRIETARY AND MAY NOT BE REPRODUCED OR OTHERWISE USED WITHOUT THE EXPRESSED WRITTEN CONSENT OF THE MEYERCORD CO.

TOLERANCES
UNLESS OTHERWISE NOTED

.X = ±.05"
.XX = ±.015"
.XXX = ±.005"
.XXXX = ±.0005
ANGLES = ±1/2°
FRACTIONS = ±1/64"

MATERIAL:

FINISH:

ALL DIMENSIONS IN INCHES UNLESS OTHERWISE NOTED
REMOVE ALL SHARP EDGES.
CONFORMANCE: ASME Y14.5M-1994

PRODUCT:
SHEET: **2 of 2**

MEYERCORD REVENUE
an ITV company
475 Village Drive
Carol Stream, Illinois 60188

Manual Tax Machine
LOGIC and CONTROL

REVISION: **1.00**

DESIGN: **EKS** DRAWN: **1/20/09**
SCALE: **1:1** APPRD: **EKS** **MTS-110**

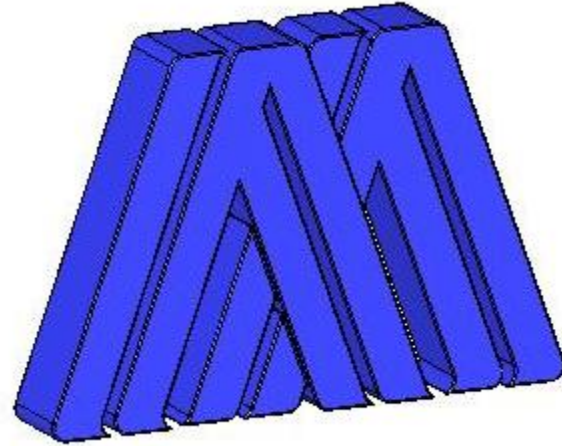

**MEYERCORD TAX STAMPING
EQUIPMENT**

Manufactured by United Silicone an ITW company

Hot Glue Unit Mechanical & Electrical Drawings (Attachment 3)

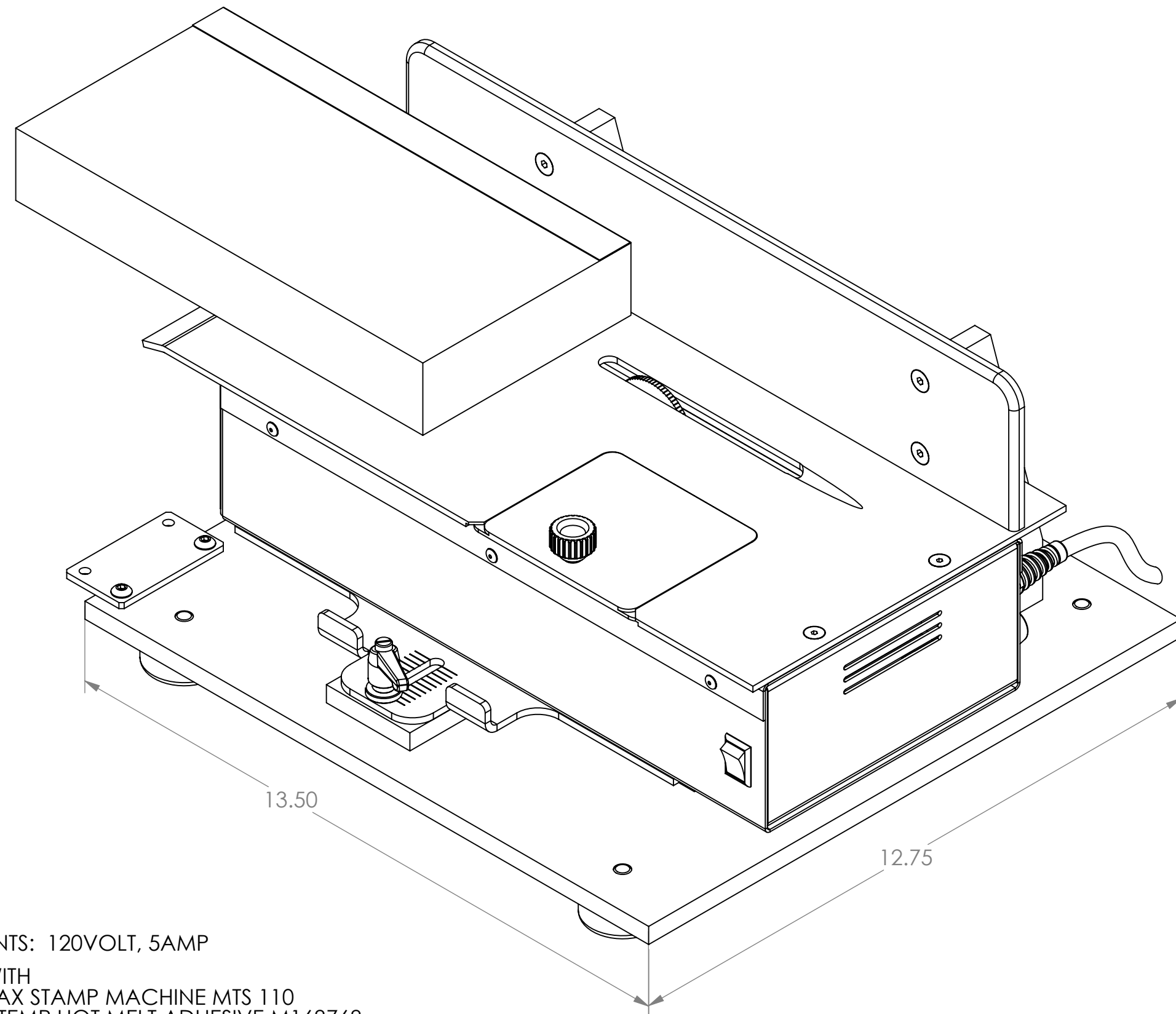

ELECTRICAL REQUIREMENTS: 120VOLT, 5AMP
 DESIGNED TO BE USED WITH
 MEYERCORD MANUAL TAX STAMP MACHINE MTS 110
 AND MEYERCORD LOW TEMP HOT MELT ADHESIVE M168768
 POSITION OF GLUE DEPOSIT WHEEL IS
 ADJUSTABLE BETWEEN 1 1/4 INCHES AND
 2 3/8 INCHES FROM BACK WALL

DRAWING NOTES

1 STAMP WITH PART NUMBER AND REVISION APPROX. WHERE SHOWN. FOR SMALLER PARTS, TAG WITH PART NUMBER.

TOLERANCES UNLESS OTHERWISE NOTED .X = ±.05" .XX = ±.015" .XXX = ±.005" .XXXX = ±.0005" ANGLES = ±1/2° FRACTIONS = ±1/64"	MATERIAL: SEE COMPONENTS
	FINISH: ALL DIMENSIONS IN INCHES UNLESS OTHERWISE NOTED. REMOVE ALL SHARP EDGES. CONFORMANCE: ASME Y14.5M-1994

PRODUCT: MTS	
SHEET: 1 OF 2	

REV.	DATE	DESCRIPTION	APP
A	02/05/2009	RELEASE FOR PRODUCTION ECN 09-1011	WBE

**HOT GLUE STATION
 MANUAL TAX STAMP MACHINE**

© THIS DOCUMENT AND THE INFORMATION CONTAINED HEREIN IS PROPRIETARY AND MAY NOT BE REPRODUCED OR OTHERWISE USED WITHOUT THE EXPRESSED WRITTEN CONSENT OF THE MEYERCORD CO.

DESIGN: WBE	DRAWN: 04/01/08	MTS-03 DWG	A DWG REV
SCALE: 1:2	APPD :		

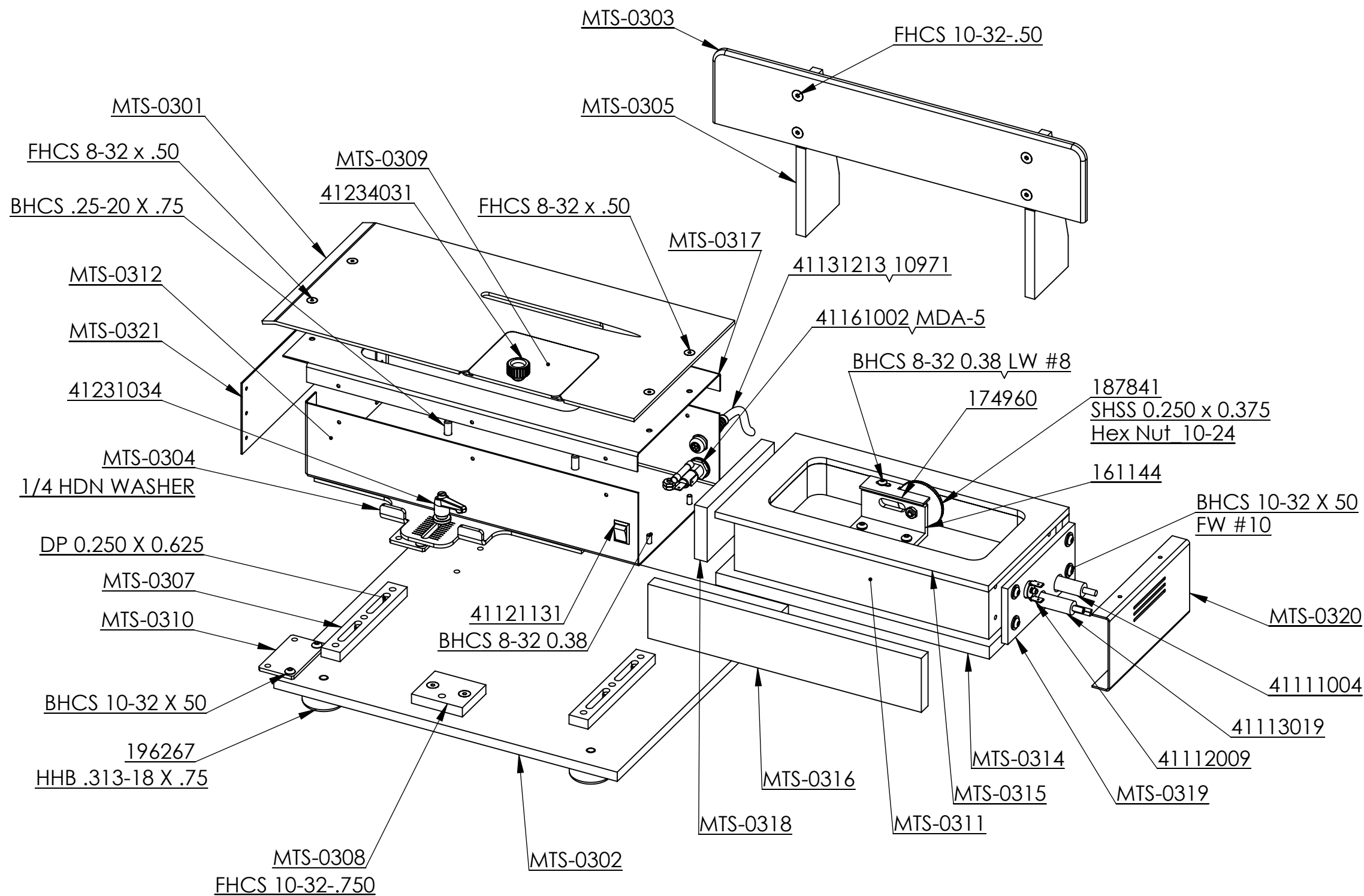

ITEM NO.	USIPN	DESCRIPTION	QTY
52		BUTTON HEAD CAP SCREW	4
51		#10 FLAT WASHER	4
50		LOCK WASHER # 10	2
49		JAM NUT	1
48		BHCS 10-32 x 3/8" LG	2
47		LOCK WASHER #8	1
46		1/8 ST STL BLIND RIVET	12
45		FLAT WASHER 1/4"	4
44		SHSS 1/4 DIA x 3/8	1
43		HEX NUT	2
42		8-32 NYLON LOCKING HEX NUT	2
41		#8-32 X 3/8 BUTT HD SCR	4
40		10-32 X 1/2 BUTTON HEAD SCR	8
39		#8-32 X 1/2 LG FL HD SCR	4
38		SPRING LOCK WASHER 5/16	4
37		5/16-18 x 3/4 HEX HD BOLT	4
36		DOWEL PIN 1/4 x 5/8	4
35		1/4 ID HARDENED WASHER	1
34		FHCS 10-32 x 1/2" LG	13
33	10971	STRAIN RELIEF/CORD GRIP	1
32	161144	BRACKET, MTG GLUE WHEEL	1
31	174960	PLATE, REGULATOR	1
30	187841	WHEEL, KNURLED GLUE	1
29	196267	RUBBER FOOT	4
28	4111004	1/2" X 8" CARTRIDGE HTR 500W 120V	1
27	41112009	DISC THERMOSTAT	1
26	41113019	ADJUSTABLE THERMOSTAT	1
25	41121131	ROCKER SWITCH	1
24	41131213	18/3 POWER CORD	1
23	41161002	FUSE HOLDER	1
22	41231034	1/4-20 CLAMP HANDLE	1
21	41234031	PLASTIC KNOB	1
20	MDA-5	TIME-DELAY FUSE	1
19	MTS-0301	GLUE POT COVER	1
18	MTS-0302	BASE PLATE	1
17	MTS-0303	BACK SLIDE PLATE	1
16	MTS-0304	GLUE POT MTG PLATE	1
15	MTS-0305	BACK GUSSET	2
14	MTS-0307	SLIDE BAR	2
13	MTS-0308	SLIDE LOCK PLATE	1
12	MTS-0309	GLUE POT FRONT LID	1
11	MTS-0310	CONNECTING STRAP	2
10	MTS-0311	GLUE POT	1
9	MTS-0312	GLUE POT BOTTOM COVER	1
8	MTS-0314	INSULATING PLATE	1
7	MTS-0315	INSULATING PLATE	1
6	MTS-0316	1/2" INSULATING PLATE	2
5	MTS-0317	TOP COVER	1
4	MTS-0318	END INSULATING PLATE	1
3	MTS-0319	INSULATING PLATE	1
2	MTS-0320	END PANEL	1
1	MTS-0321	END PLATE	1

TOLERANCES
UNLESS OTHERWISE NOTED
.X = ±.05"
.XX = ±.015"
.XXX = ±.005"
.XXXX = ±.0005
ANGLES = ±1/2°
FRACTIONS = ±1/64"

MATERIAL:
SEE COMPONENTS

FINISH:

ALL DIMENSIONS IN INCHES UNLESS OTHERWISE NOTED.
REMOVE ALL SHARP EDGES.
CONFORMANCE: ASME Y14.5M-1994

PRODUCT: MTS
SHEET: 2 OF 2

MEYERCORD
Tax Stamping Equipment

HOT GLUE STATION MANUAL TAX STAMP MACHINE

REV.	DATE	DESCRIPTION	APP
A	02/05/09	RELEASE FOR PRODUCTION ECN 09-1011	WBE

© THIS DOCUMENT AND THE INFORMATION CONTAINED HEREIN IS PROPRIETARY AND MAY NOT BE REPRODUCED OR OTHERWISE USED WITHOUT THE EXPRESSED WRITTEN CONSENT OF THE MEYERCORD CO.

DESIGN: WBE DRAWN: 04/01/08 MTS-03 A
SCALE: 1:3 APPRD: DWG DWG REV

100
101
102
103
104
105
106
107
108
109
110
111
112
113
114
115
116
117
118

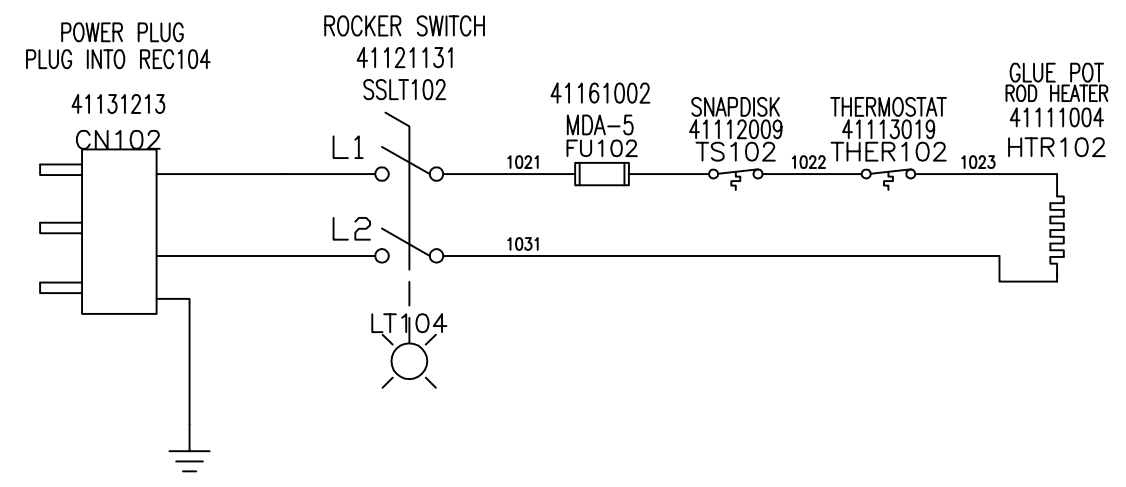

121
122
123
124
125
126
127
128
129
130
131
132
133
134
135
136
137
138
139

REV	DATE	DESCRIPTION	APP	REV	DATE	DESCRIPTION	APP

THIS DOCUMENT AND THE INFORMATION CONTAINED HEREIN IS PROPRIETARY AND MAY NOT BE REPRODUCED OR OTHERWISE USED WITHOUT THE EXPRESSED WRITTEN CONSENT OF THE MEYERCORD CO.

TOLERANCES
UNLESS OTHERWISE NOTED
.X = ±.05'
.XX = ±.015'
.XXX = ±.005'
.XXXX = ±.0005'
ANGLES = ±1/2°
FRACTIONS = ±1/64'

MATERIAL:

FINISH:

ALL DIMENSIONS IN INCHES UNLESS OTHERWISE NOTED
REMOVE ALL SHARP EDGES.
CONFORMANCE: ASME Y14.5M-1994

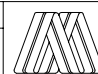
PRODUCT: SHEET: 1 of 1	 MEYERCORD REVENUE an ITW company 475 Village Drive Carol Stream, Illinois 60188
HOT GLUE STATION CONTROL SCHEMATIC REVISION: 1.00	
DESIGN: EKS	DRAWN: 2/4/09
SCALE: 1:1	APPRD: EKS
MTS	